

# KLF 150



**VELUX®**



ENGLISH



VAS 455497-2025-05

Two instructions are supplied with the interface (**A** and **B**).

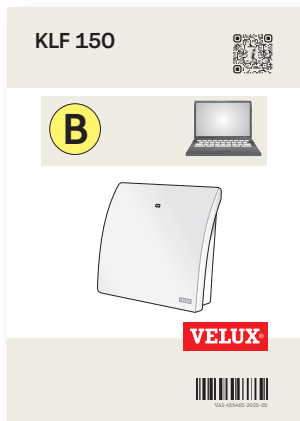
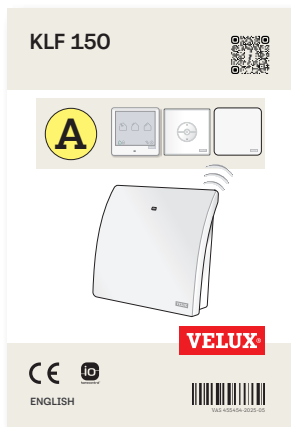

Set-up via control pad KLR 200

# Contents

## **Congratulations on your new VELUX product!**

Thank you for buying this VELUX product.

The product can be used as an interface or as a repeater.

The interface function is used when io-homecontrol® products are to be controlled via external control devices that are not io-homecontrol® compatible.

The repeater function is used if you want to extend the operation range of controls in the system by transmitting received wireless commands.

<b>Contents of packaging</b>	4
<b>Product overview</b>	5
<b>Default settings</b>	5
<b>Important information</b>	6-8
<b>Function as interface</b>	
Function of inputs	9-11
Registration of products	12
Registration with VELUX two-way control pad KLR 300	13-17
Registration with VELUX one-way control	18-19
Function of outputs	20
Resetting	21
<b>Function as repeater</b>	22-26
<b>Own notes</b>	27

# Contents of packaging

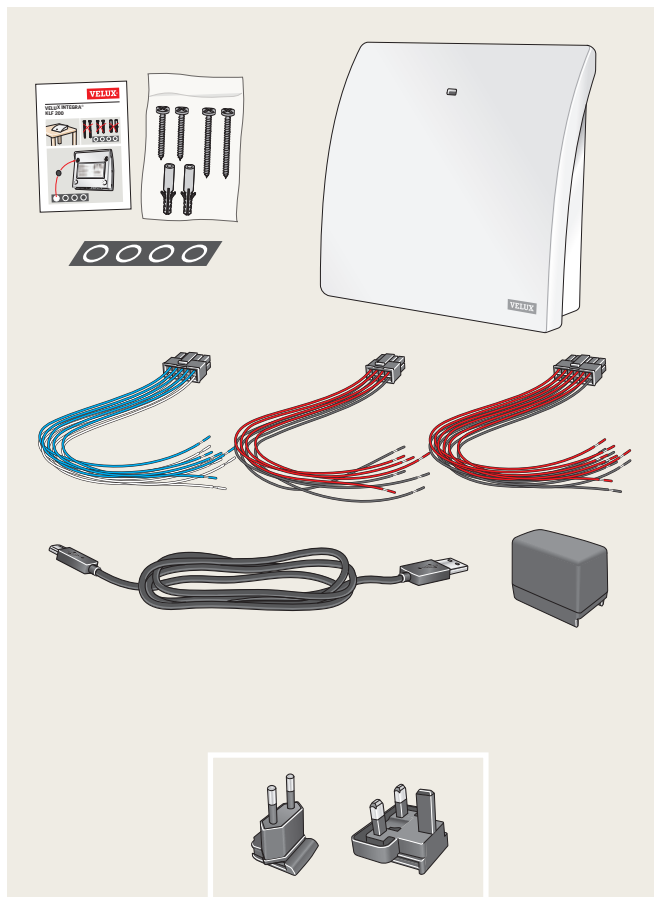

# Product overview

## Default settings

### Product overview

- ① Light-emitting diode
- ② Power supply
- ③ Key button
- ④ RESET
- ⑤ Outputs
- ⑥ Inputs

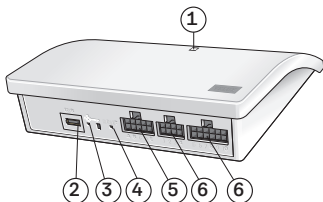

### Default settings

#### Inputs (control)

An external control signal shorter than 1.5 seconds makes the VELUX product travel to end position.

- Even inputs (2, 4, 6, 8) are used for close/down: The product travels to end position
- Odd inputs (1, 3, 5, 7) are used for open/up: The product travels to end position

An external control signal longer than 1.5 seconds makes the VELUX product travel until the signal stops or until the product has reached end position.

Default speed is used for all window operators including those supporting silent mode.

As default, io-homecontrol® channel 3 is used for communication and no channels or signals are blocked.

#### Outputs (signals)

The output relay is activated for 2 seconds when an action has been successfully executed.

The default settings can be adjusted by using the web interface.

See enclosed instruction leaflet **B**.



Read instructions carefully before installation and operation. Keep instructions for future reference and hand them over to any new user.

## Safety

- VELUX interface KLF 150 can be used by persons (aged 8 years and above) with sufficient experience and knowledge if they have been given instruction concerning safe use and understand the hazards involved. Cleaning and user maintenance must not be done by unsupervised children.
- Children must not play with the interface.
- The interface, adaptor plug and cable are for indoor use only.
- The interface must not be covered (maximum ambient temperature: 50 °C).
- The interface must be installed at a height below 2 m from floor level.
- If the adaptor plug and/or cable is/are damaged, it/they must be replaced.

## Product

- The interface is based on two-way RF (radio frequency) communication and marked with the symbol . This symbol can be found on the data label.
- Cables from the interface input must not exceed 100 m.
- Radio frequency band: 868 MHz, maximum radio frequency power transmitted: < 25 mW.

# Important information

- Radio frequency range: 300 m free field. Depending on building construction, the indoor range is approx. 30 m. However, constructions with reinforced concrete, metal ceilings and plaster walls with steel members may reduce the range.
- The packaging must be disposed of in accordance with national regulations.
-  The product, including batteries if any, is regarded as electrical and electronic equipment and contains hazardous materials, components and substances. The crossed out wheeled bin symbolises that electrical and electronic equipment waste must not be disposed of together with household waste. It must be collected separately at recycling stations or other collection sites or retrieved directly from households to increase the possibilities of recycling, reuse and utilisation of electrical and electronic equipment waste. By sorting electrical and electronic equipment waste with this symbol, you contribute to reducing the volume of incinerated or buried waste and to reducing any negative impact on human health and the environment. Further information can be obtained from the local municipality's technical administration or from your VELUX sales company.

## Maintenance

- If repair or adjustment work is needed, disconnect any power supply and ensure that it cannot be reconnected unintentionally.
- The interface requires a minimal amount of maintenance. The surface may be cleaned with a soft, damp cloth.
- Spare parts are available from your VELUX sales company. Please provide information from the data label.
- If you have any technical questions, please contact your VELUX sales company, see telephone list or [www.velux.com](http://www.velux.com).



io-homecontrol® provides advanced and secure radio technology that is easy to install. io-homecontrol® labelled products communicate with each other, improving comfort, security and energy savings.

[www.io-homecontrol.com](http://www.io-homecontrol.com)

# Important information



## DECLARATION OF CONFORMITY

We herewith declare that VELUX interface KLF 150  
(3LF DK50 EU/BS-RC018-XX)

- is in conformity with the Low Voltage Directive 2014/35/EU, the EMC Directive 2014/30/EU, the Radio Equipment Directive 2014/53/EU and the RoHS Directive 2011/65/EU,
- has been manufactured in accordance with the harmonised standards EN 62368-1(2014), EN 55032(2015) + A11(2020), EN 55035(2017) + A11(2020), EN 62233(2008) and EN 62311 and
- has been assessed in accordance with the harmonised standard EN 63000(2018).

VELUX A/S: ..... *Jens Aksel Thomsen* .....  
(Jens Aksel Thomsen, Advanced Certification Specialist)

Ådalsvej 99, DK-2970 Hørsholm ..... 04.04.2025 .....

CE DoC 940448-00



# Function as interface

## Function of inputs

Function as interface is used when io-homecontrol® products are to be controlled by external control devices that are not io-homecontrol® compatible.

The inputs on the interface must be connected to control devices with potential free contacts. When the potential free contact is activated, the interface sends a wireless command to the io-homecontrol® products to be operated. It is possible to operate a single product or a group of products (up to 200 products in total).

The window can also be operated with the wireless control, if preferred.

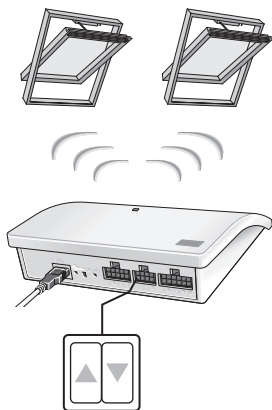

Individual control of a product or a product group requires a double input per product or product group, ie input 1 and 2 belong together, input 3 and 4, input 5 and 6 etc. This means that up to five products or product groups can be configured.

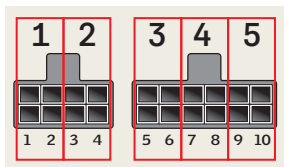

# Function as interface

## Function of inputs

Standard setting of inputs:

**OPEN/UP/ON** is controlled by connecting **1**  and

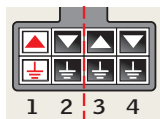

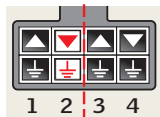
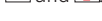

**CLOSE/DOWN/OFF** is controlled by connecting **2**

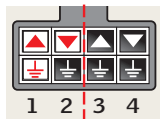
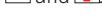

**STOP** is controlled by connecting both **1**  and **2**



The top rows in the **INPUT** terminals are signal  / . The bottom rows in the **INPUT** terminals are common ground .

## Thermostatic control of a VELUX roof window by a non io-homecontrol® compatible thermostat

A thermostat can be used for controlling automatic opening and closing of windows depending on the temperature. A typical thermostat works by means of a potential free change-over contact that switches between two positions depending on the ambient temperature.

A thermostat set to 22 °C will typically change positions (ie open the window(s)) when the temperature rises above 23 °C, and switch back (ie close the window(s)) when the temperature has again fallen below 21 °C.

The window can also be operated with the wireless control, if preferred.

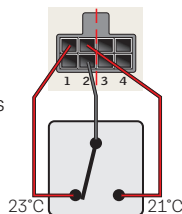

# Function as interface

## Function of inputs

A single contact can be used for running products either up or down, for instance for a blind.

Short press (under 1.5 seconds): The product will run to end position.

Long press: The product will run until the key is released.

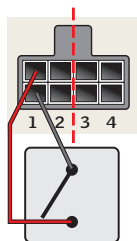

A set of two contacts can be used for running products both up and down with variable stops by pressing both contacts simultaneously.

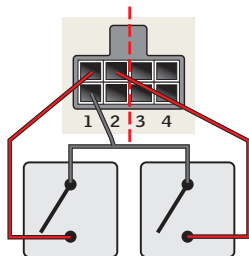

A change-over contact can also be used for running products both up and down but stops are not possible, for instance for a thermostat.

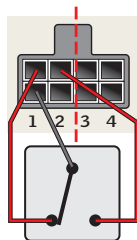

# Function as interface

## Registration of products

io-homecontrol® products must be registered in the interface to be operational. You can register and operate up to 200 products.

If you have a VELUX two-way control pad KLR 300 (labelled with the symbol ) , you can copy the registered products from the control pad to the interface. See how on pages 13-17.



If you **only** have a VELUX one-way control (labelled with the symbol ) , you can copy the products operated by this control to the interface. See how on pages 18-19.



**Note:** If you have both a one-way and a two-way control, you can copy the registered products from both controls using VELUX two-way control pad KLR 300.

# Function as interface

## Registration with VELUX two-way control pad KLR 300

The illustrations below show how to copy the contents from control pad KLR 300 to interface KLF 150.



**1**

Connect the interface to the power supply. When the light-emitting diode flashes yellow, the interface is ready for configuration.

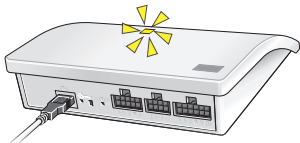

**2**

Slide the battery case off your control pad KLR 300.

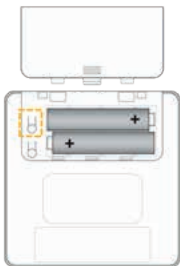

# Function as interface

## Registration with VELUX two-way control pad KLR 300

- 3** Press and hold the key icon on the control pad until it flashes green rapidly (within 2 to 8 seconds) 

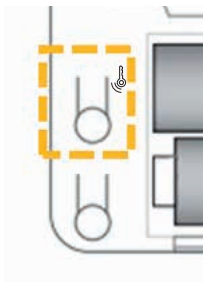

- 4** Do a short press on the key icon on KLF 150 (1 sec.)
- The light-emitting diode next to the key button will turn solid green, indicating a successful key transfer.
  - Your KLF 150 should now flash white.
  - The key between your KLF 150 and KLR 300 has now been exchanged.

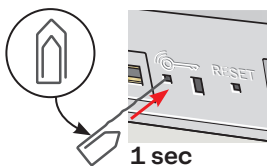

# Function as interface

## Registration with VELUX two-way control pad KLR 300

5

Choose the product(s) to be controlled by KLF 150.

Tap 

Tap 

Tap 

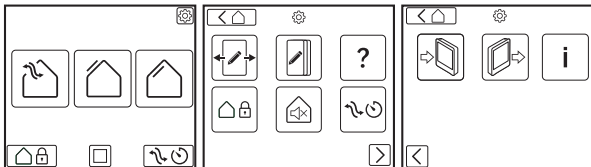

6

Tap 

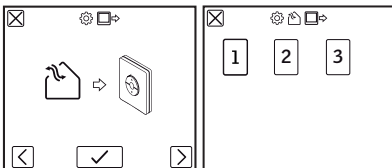

Choose the product(s) to be controlled by KLF 150.

Tap  x 2

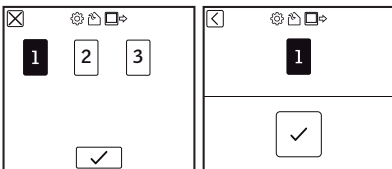

Your product should now wink.

You are now done with your control pad KLR 300.

# Function as interface

## Registration with VELUX two-way control pad KLR 300

7

Briefly press the reset button.

The light-emitting diode should now flash white rapidly.

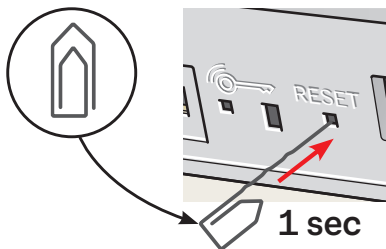

8

Connect the supplied wire bundle to the input terminal.

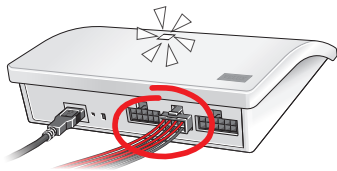



# Function as interface

## Registration with VELUX two-way control pad KLR 300

- 9** Short-circuit wires (1 second) in the double input which is to control the chosen product(s). It can take up to 1 minute before the light-emitting diode flashes green and the product(s) is/are assigned to the input terminal on the interface.

**Note:** When short-circuiting the same input again, previous configurations will be replaced. This means that if a product is to be added to a group which has already been configured, all the products in the group have to be added again.

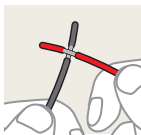

**1 sec**

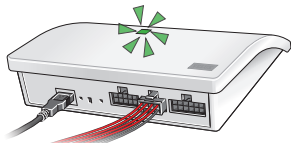

- 10** When the white light-emitting diode is on, interface KLF 150 has been configured as an interface. The configuration may take up to several minutes.

**Note:** If you want to add more products to the interface, repeat steps 5-9.

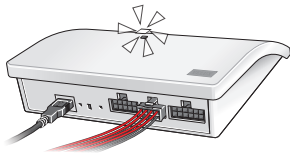

# Function as interface

## Registration with VELUX one-way control

- 1** The illustrations below show how to copy the contents from a one-way control to interface KLF 150.

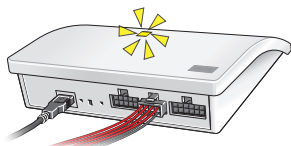

Connect the interface to the mains supply and connect the supplied wire bundle to the input terminal. When the light-emitting diode flashes yellow, the interface is ready for configuration.

- 2** Press the  button at the bottom of the control with a pointed object.

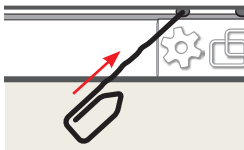

- 3** Press the RESET button on the back of the interface briefly (1 second) with a pointed object. The light-emitting diode flashes white. Step 4 must now be carried out within 2 minutes.



**1 sec**

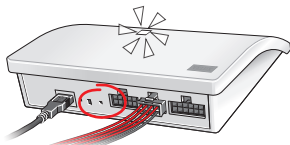

# Function as interface

## Registration with VELUX one-way control

- 4** Short-circuit wires (1 second) in the double input which is to control the chosen product(s). The light-emitting diode flashes green.

**Note:** When short-circuiting the same input again, previous configurations will be replaced. This means that if a product is to be added to a group which has already been configured, all the products in the group have to be added again.

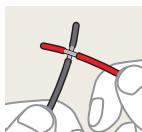

1 sec

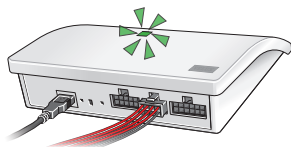

- 5** When the white light-emitting diode is on, interface KLF 150 has been configured as an interface.

**Note:** If you want to add more products to the interface, repeat steps 1-4.

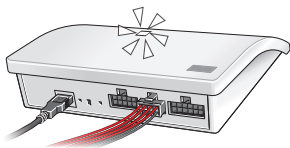

# Function as interface

## Function of outputs

The output function is used together with an intelligent building installation (IBI) to get feedback from KLF 150. The output function gives the user feedback as to whether an action has been executed, eg if the window has been closed. As feedback, the built-in output relay is activated for 2 seconds.

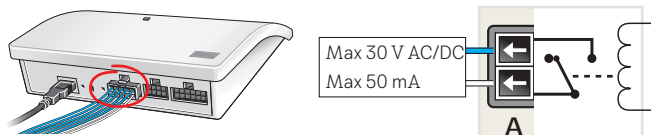

## Intelligent building installations

io-homecontrol® products can be combined with most intelligent building installations (IBI). The IBI system must include an output module with one or more programmable outputs. When the outputs from the IBI have been connected to the input terminals on the interface, the relevant io-homecontrol® products can be controlled via the interface. With two outputs it is possible to control both of the functions ▲ and ▼ in an io-homecontrol® product or a group of io-homecontrol® products.

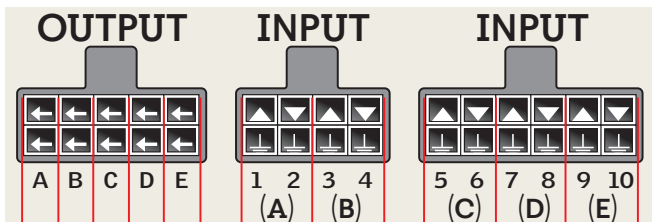

**OUTPUT A** connects to **INPUT 1** and **2**.  
**OUTPUT B** connects to **INPUT 3** and **4** etc.

# Function as interface

## Resetting

When resetting, **all** settings will be deleted and the interface reset to factory settings.

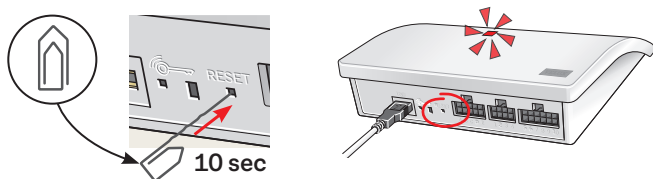

Press the RESET button on the back of the interface for 10 seconds with a pointed object until the red light-emitting diode is on. After this, the light-emitting diode will turn yellow followed by a red flash.

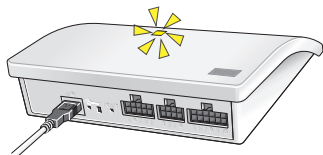

When the light-emitting diode flashes yellow, the interface has been reset. This may take up to 1 minute.

# Function as repeater

## Registration with VELUX two-way control pad KLR 300

The repeater function extends the operation range of controls in the system by transmitting received wireless commands. When used as a repeater, the interface is therefore to be placed approximately halfway between the controls and the io-homecontrol® products to be operated.

The repeater function must be registered in two-way controls as if it were a product in the same way as other io-homecontrol® products.

**Note:** The repeater function cannot be used with one-way controls.

Up to three interfaces in a system can be set to repeater function.

The operation range of controls cannot be extended further in the same direction by placing more repeaters after each other as commands can be sent only via one repeater.



# Function as repeater

## Registration with VELUX two-way control pad KLR 300

- 1** Press the RESET button on the back of the KLF 150 for 5 seconds with a pointed object until the light-emitting diode emits red light. Subsequently, the light-emitting diode flashes yellow.

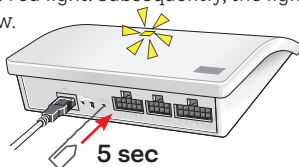

- 2** On your control pad KLR 300 tap

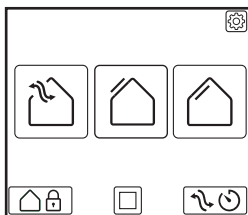

- 3** Tap

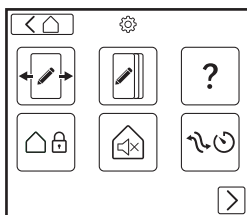

- 4** Tap

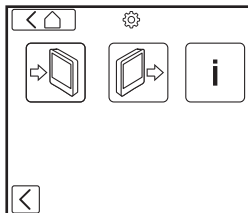

- 5** Tap

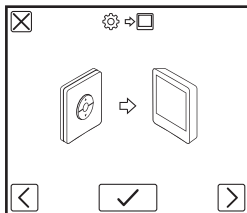

# Function as repeater

Registration with VELUX two-way control pad KLR 300

6 Tap ☒ x 2

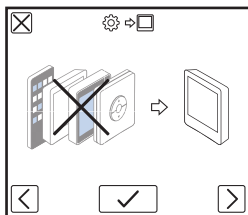

7 KLR 300 will display "no products found" – tap ☒

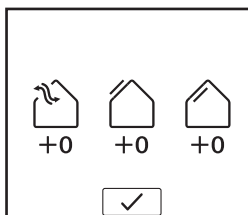

8 When the blue light-emitting diode is on, the interface is configured as a repeater.





# Function as repeater

## Registration with VELUX ACTIVE gateway

The repeater function extends the operation range of controls in the system by transmitting received wireless commands. When used as a repeater, the interface is therefore to be placed approximately halfway between the controls and the io-homecontrol® products to be operated.

The repeater function must be registered in two-way controls as if it were a product in the same way as other io-homecontrol® products.

**Note:** The repeater function cannot be used with one-way controls.

Up to three interfaces in a system can be set to repeater function.

The operation range of controls cannot be extended further in the same direction by placing more repeaters after each other as commands can be sent only via one repeater.

## Registration with VELUX ACTIVE gateway

KLF 150 is registered with VELUX ACTIVE gateway by using the gateway buttons only.

**Note:** KLF 150 does not extend the range of VELUX ACTIVE indoor climate sensor and departure switch.



# Function as repeater

## Registration with VELUX ACTIVE gateway

- 1 Press the RESET button on the back of the KLF 150 for 5 seconds with a pointed object until the light-emitting diode emits red light. Subsequently, the light-emitting diode flashes yellow.

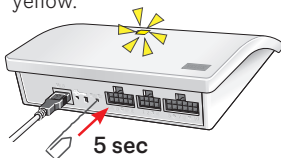

- 2 Register KLF 150 by pressing the gear button on the back of the gateway for 10 seconds until the light from the flashing light-emitting diode changes colour from white to blue.

After 1 minute, the light-emitting diode is switched off.

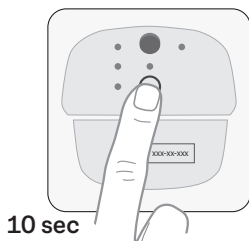

- 3 KLF 150 is configured as a repeater when the light-emitting diode is constantly emitting blue light.

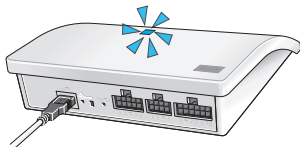

# Own notes

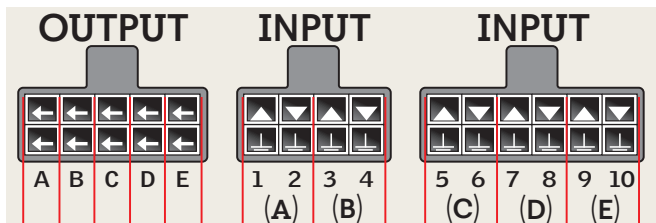

	Product
A	
B	
C	
D	
E	
1 2	
3 4	
5 6	
7 8	
9 10	



<b>AR:</b>	VELUX Export (VELUX A/S) + 45 4516 7885	<b>IT:</b>	VELUX Italia s.p.a. 045/6173666
<b>AT:</b>	VELUX Österreich GmbH 02245/32 3 50	<b>JP:</b>	VELUX-Japan Ltd. 0570-00-8141
<b>AU:</b>	VELUX Australia Pty. Ltd. 1300 859 856	<b>KR:</b>	VELUX Export (VELUX A/S) + 45 4516 7885
<b>BA:</b>	VELUX Bosna i Hercegovina d.o.o. 033/626 493, 626 494	<b>LT:</b>	VELUX Lietuva, UAB (85) 270 91 01
<b>BE:</b>	VELUX Belgium (010) 42.09.09	<b>LV:</b>	VELUX Latvia SIA 67 27 77 33
<b>BG:</b>	ВЕЛУКС България ЕООД 02/955 99 30	<b>NL:</b>	VELUX Nederland B.V. 030 - 6 629 629
<b>CA:</b>	VELUX Canada Inc. 1 800 88-VELUX (888-3589)	<b>NO:</b>	VELUX Norge AS 22 51 06 00
<b>CH:</b>	VELUX Schweiz AG 062 289 44 45	<b>NZ:</b>	VELUX New Zealand Ltd. 0800 650 445
<b>CL:</b>	VELUX Export (VELUX A/S) + 45 4516 7885	<b>PL:</b>	VELUX Polska Sp. z o.o. (022) 33 77 000 / 33 77 070
<b>CN:</b>	VELUX (CHINA) CO. LTD. 0316-607 27 27	<b>PT:</b>	VELUX Portugal, Lda 21 880 00 60
<b>CZ:</b>	VELUX Česká republika, s.r.o. 531 015 511	<b>RO:</b>	VELUX România S.R.L. 0268-402740
<b>DE:</b>	VELUX Deutschland GmbH www.velux.de/kontakt	<b>RS:</b>	VELUX Srbija d.o.o. 011 20 57 500
<b>DK:</b>	VELUX Danmark A/S 45 16 45 16	<b>SE:</b>	VELUX Svenska AB 042/20 83 80
<b>EE:</b>	VELUX Eesti OÜ 621 7790	<b>SI:</b>	VELUX Slovenija d.o.o. 01 724 68 68
<b>ES:</b>	VELUX Spain, S.A.U. 91 509 71 00	<b>SK:</b>	VELUX Slovensko, s.r.o. (02) 33 000 555
<b>FR:</b>	VELUX France 0806 80 15 15 Service gratuit + prix appel	<b>TR:</b>	VELUX Çatı Pencereleri Ticaret Limited Şirketi 0 216 302 54 10
<b>GB:</b>	VELUX Company Ltd. 01592 778 225	<b>UA:</b>	ТОВ "ВЕЛЮКС Україна" (044) 2916070
<b>HR:</b>	VELUX Hrvatska d.o.o. 01/5555 444	<b>US:</b>	VELUX America LLC 1-800-88-VELUX
<b>HU:</b>	VELUX Magyarország Kft. (06/1) 436-0601		
<b>IE:</b>	VELUX Company Ltd. 01 848 8775		