

EAZ/EAW/EAS

EAZ

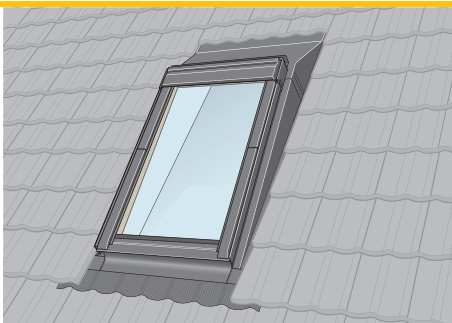
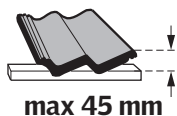

Pages 2-12
Pages 14-19

EAW

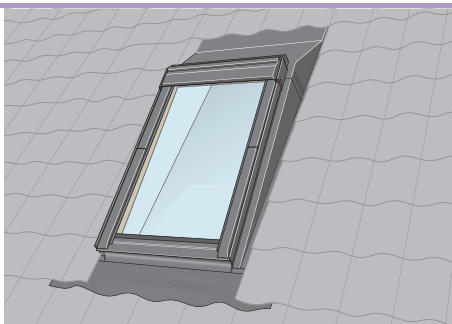
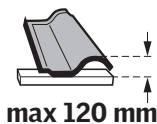

Pages 2-12
Pages 20-25

EAS

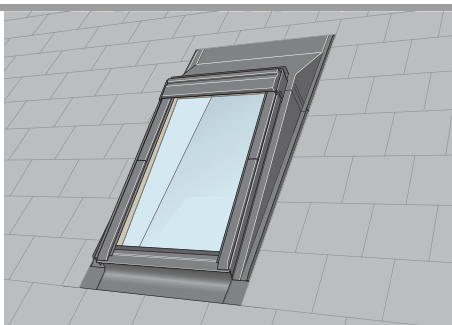
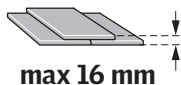

Pages 2-12
Pages 26-31



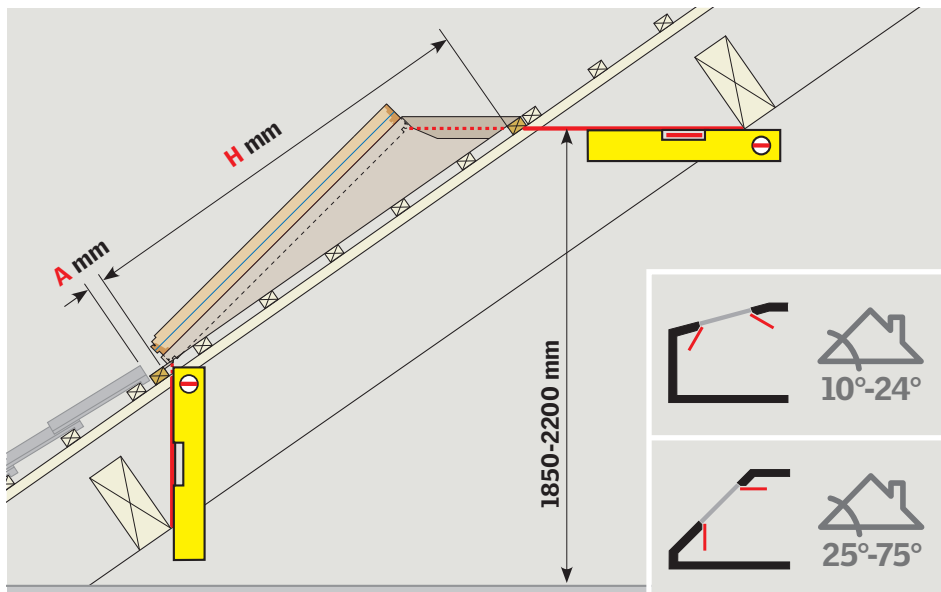
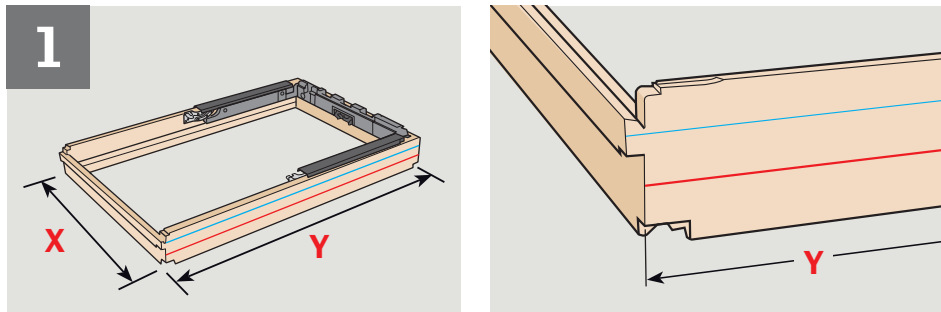

Y	H
980 mm (-K04)	1360 mm
1180 mm (-K06)	1630 mm
1400 mm (-K08)	1930 mm
1600 mm (-K10)	2200 mm

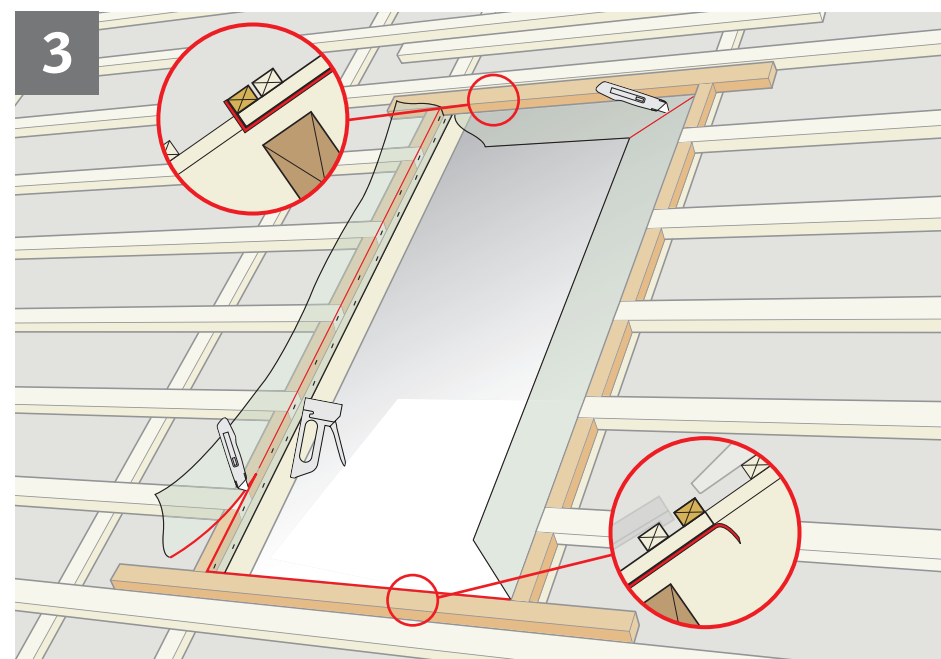
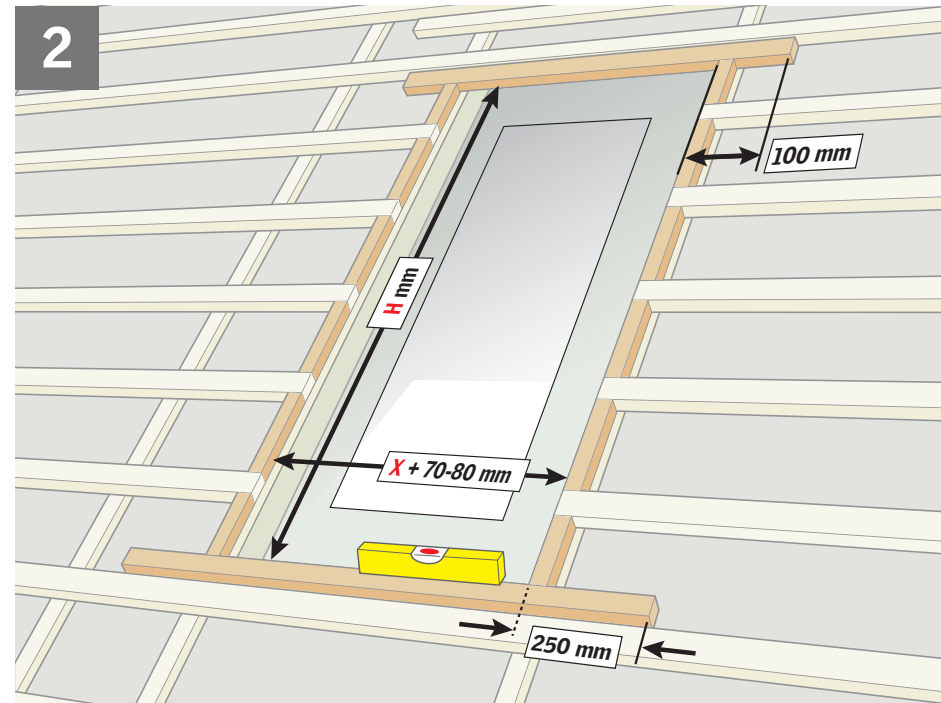
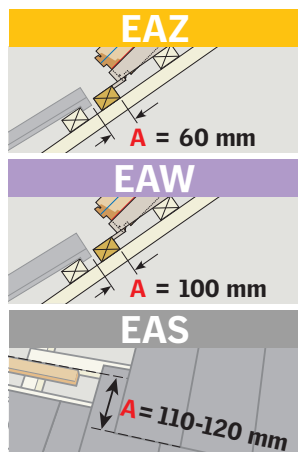

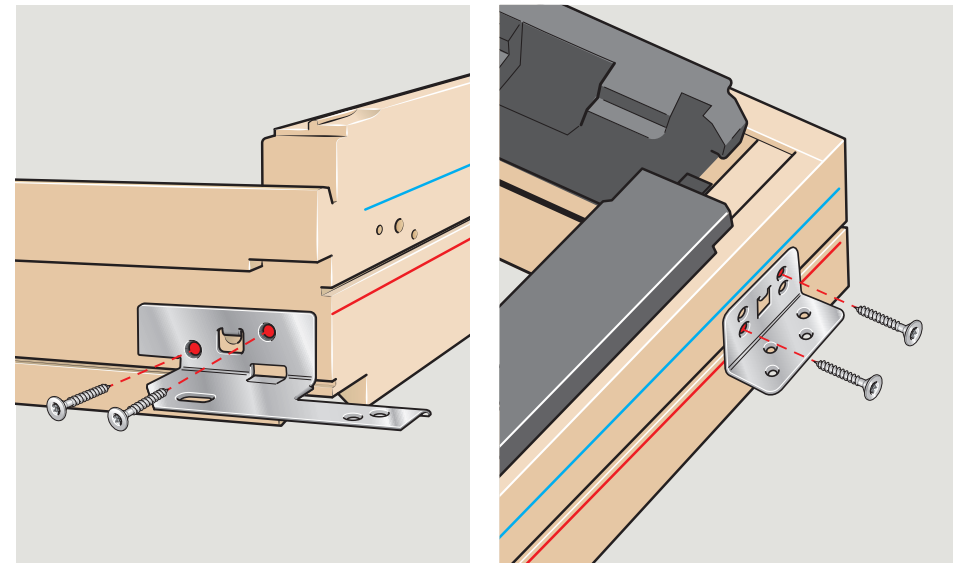
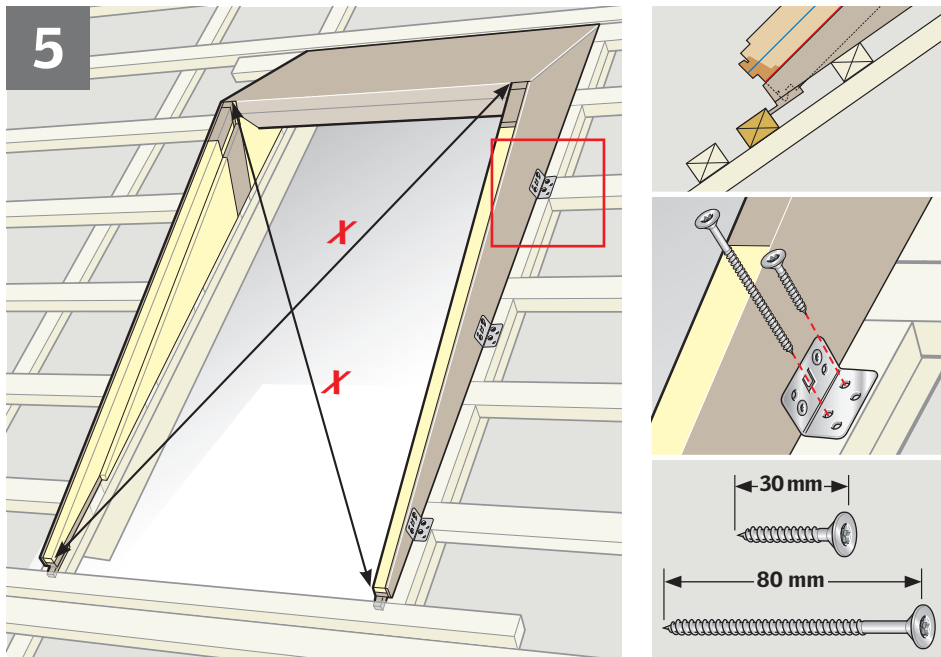
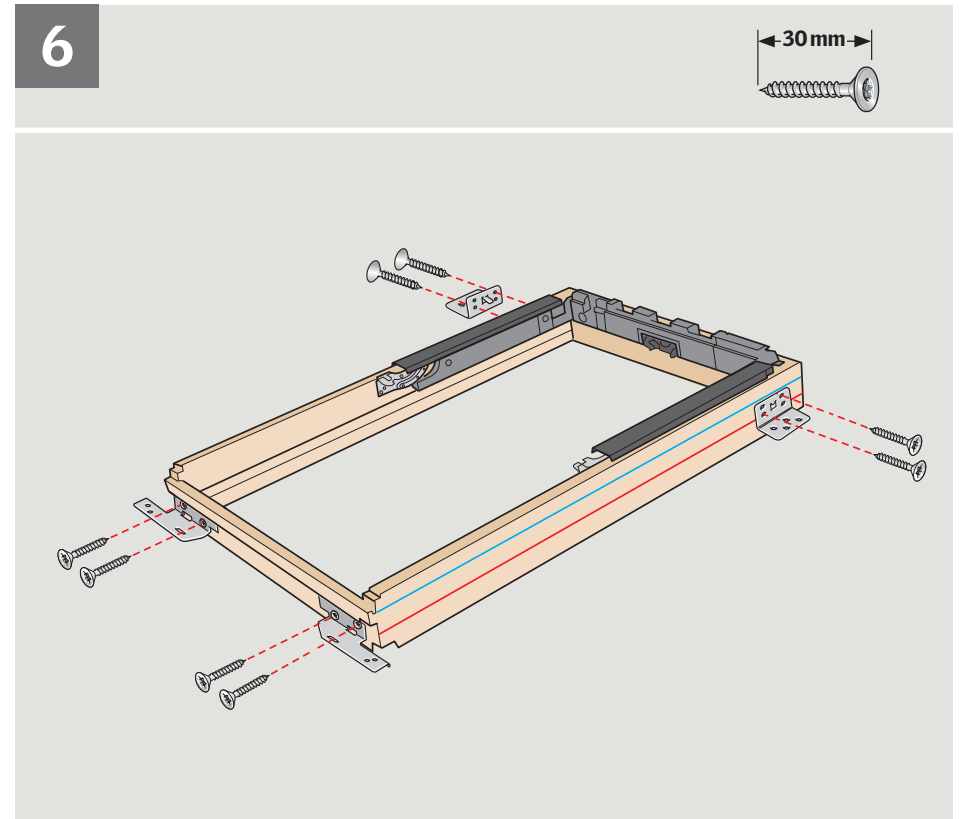
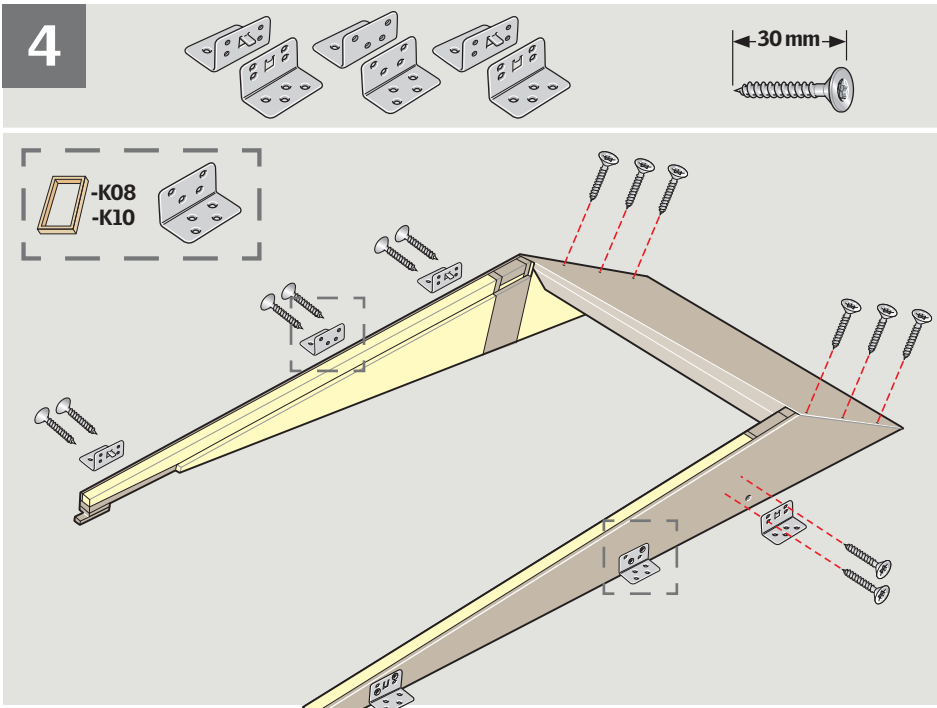

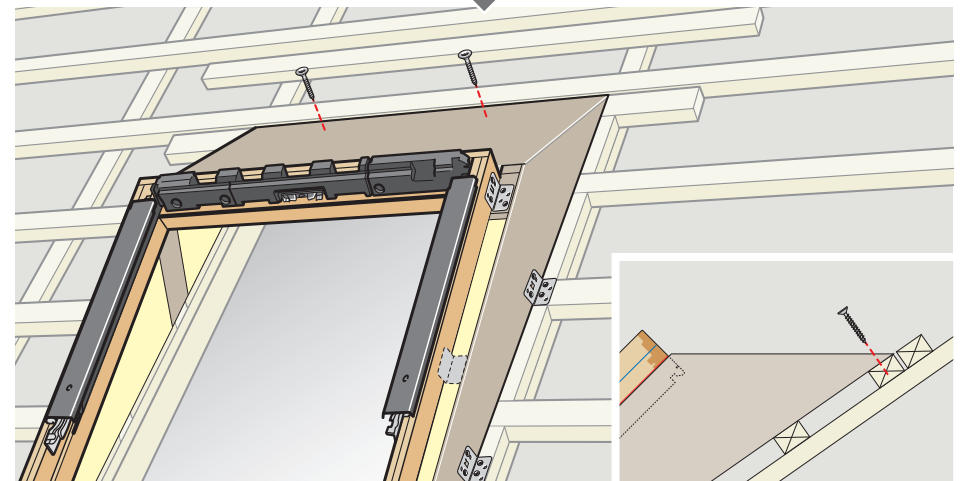
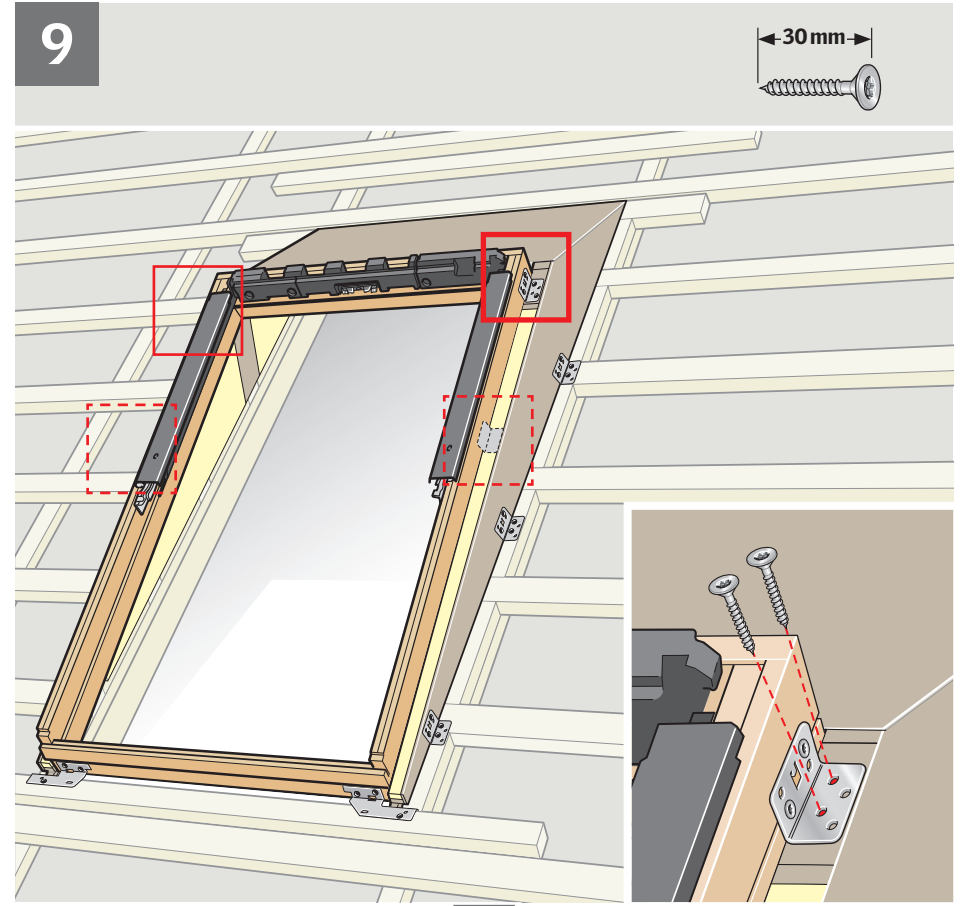
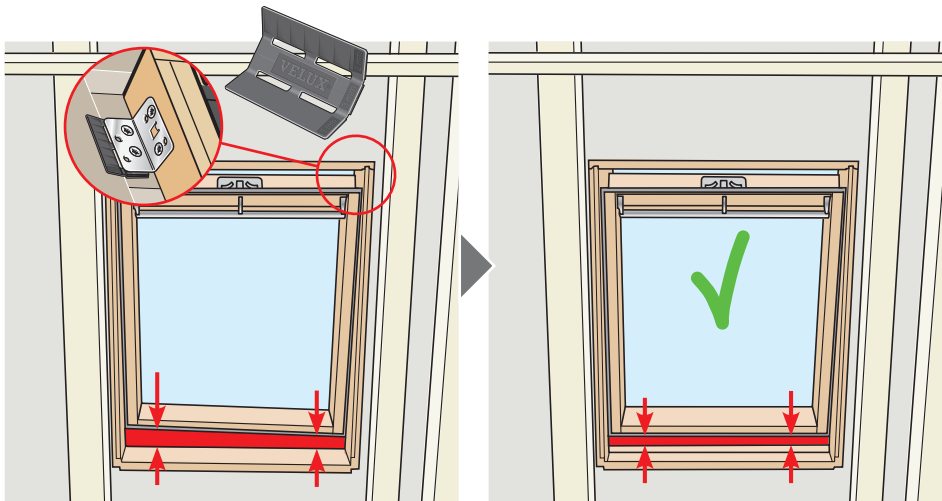
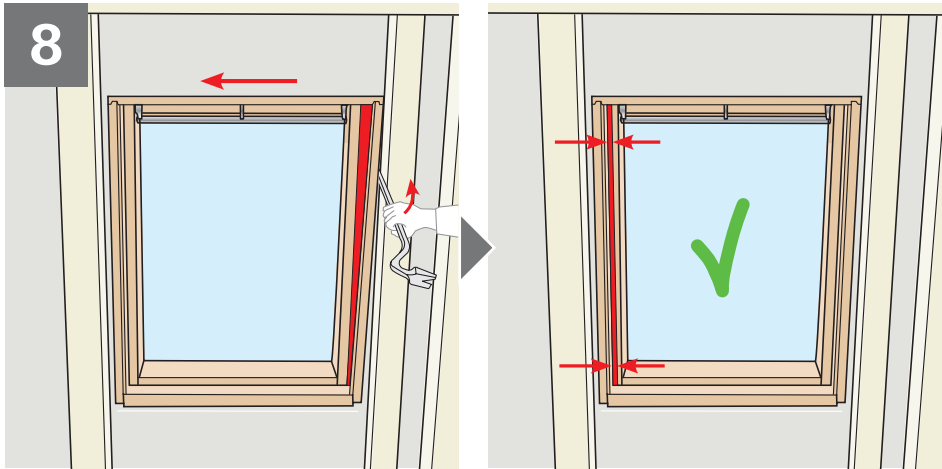
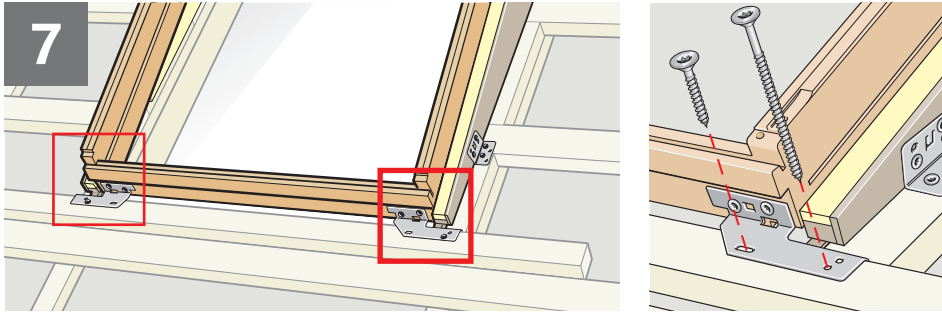

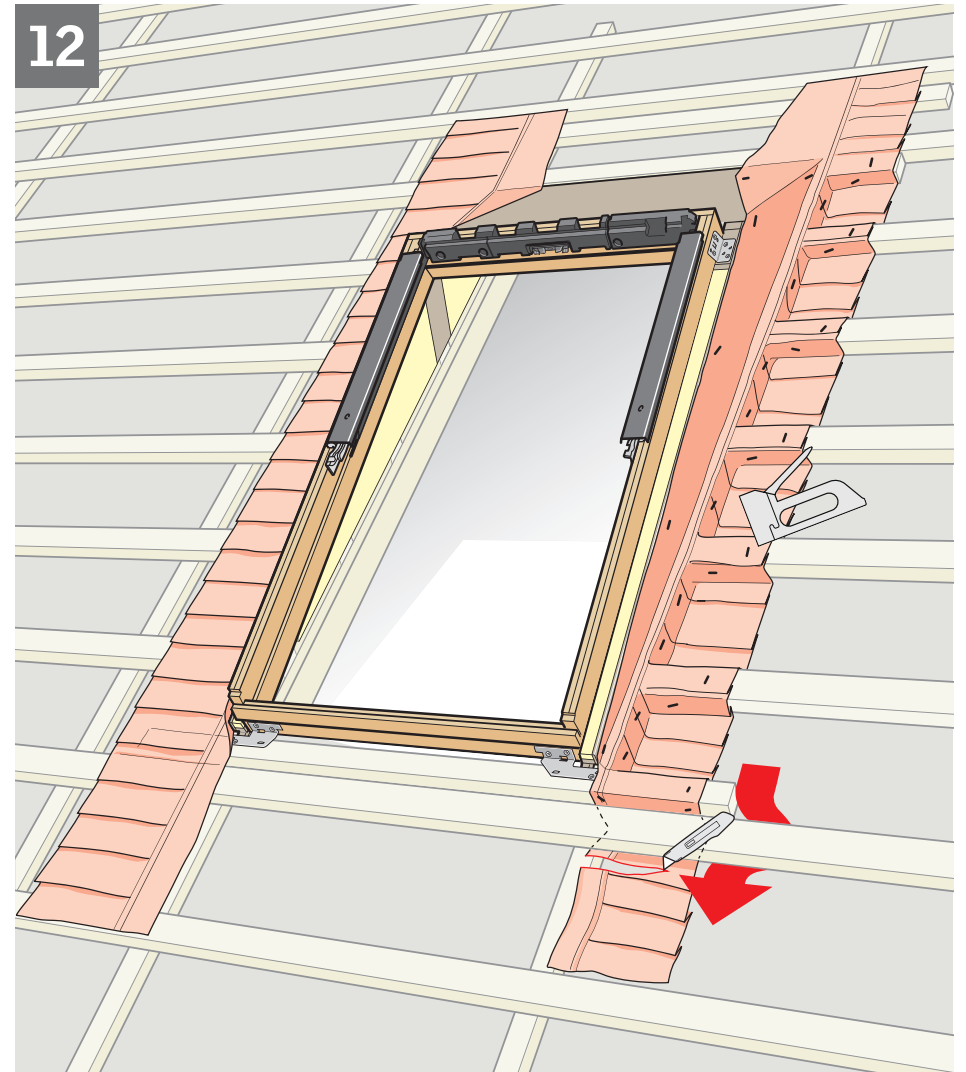
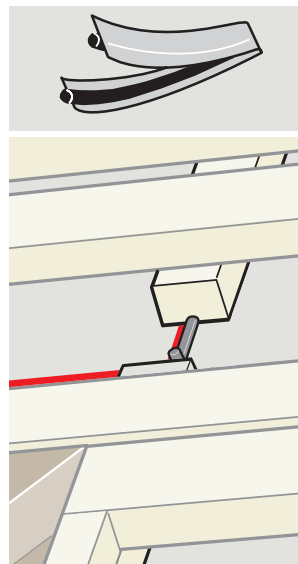
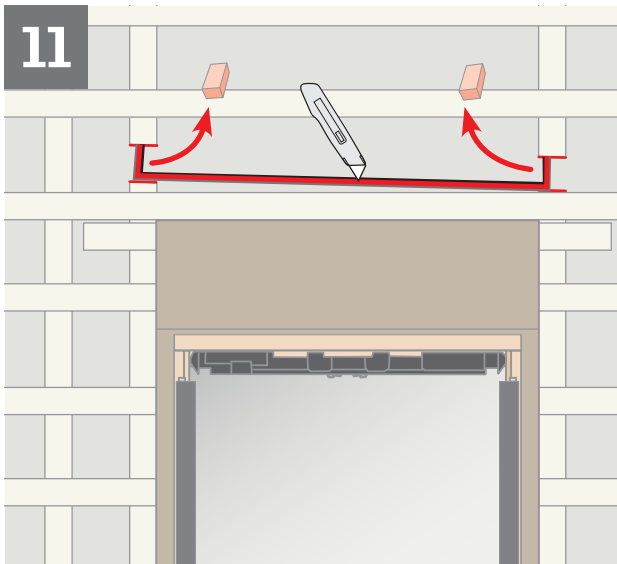
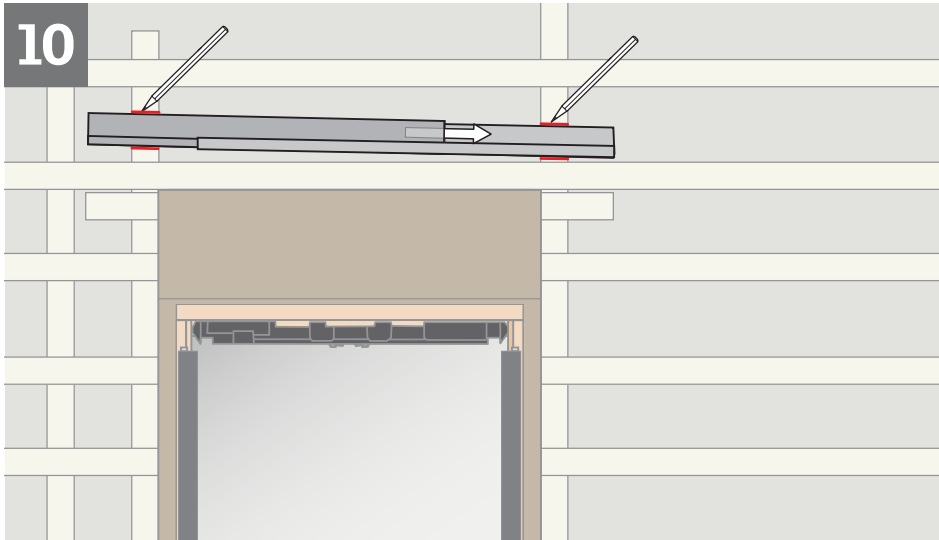
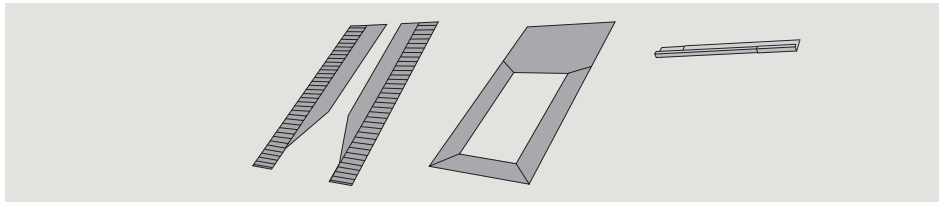

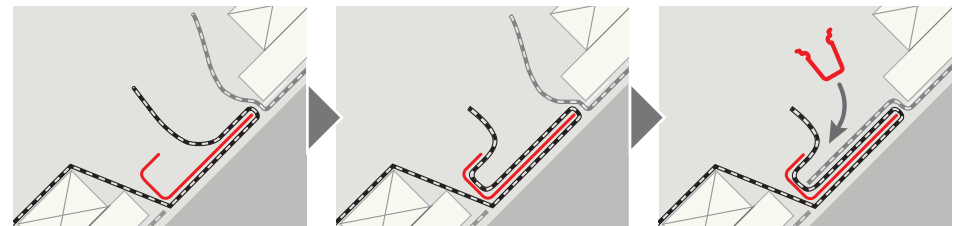
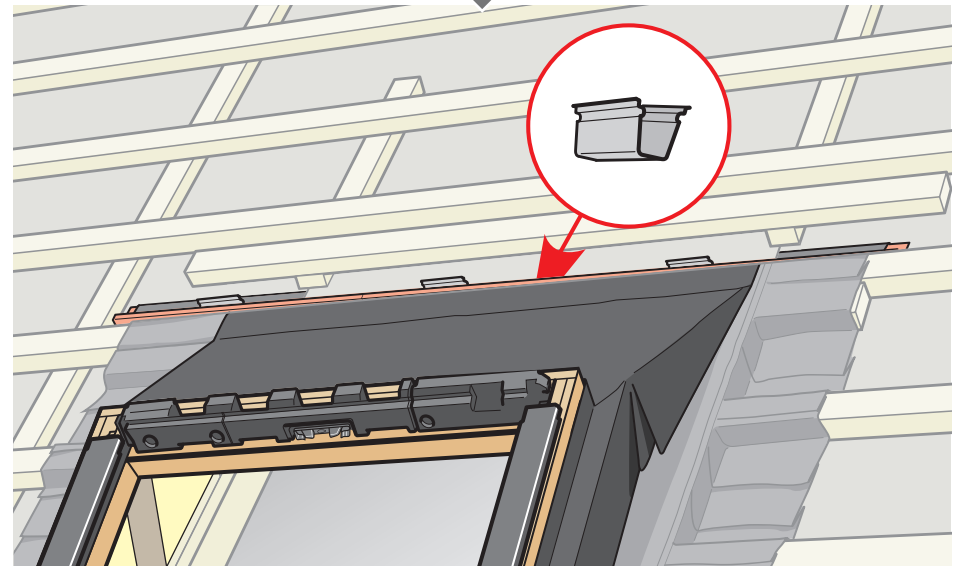
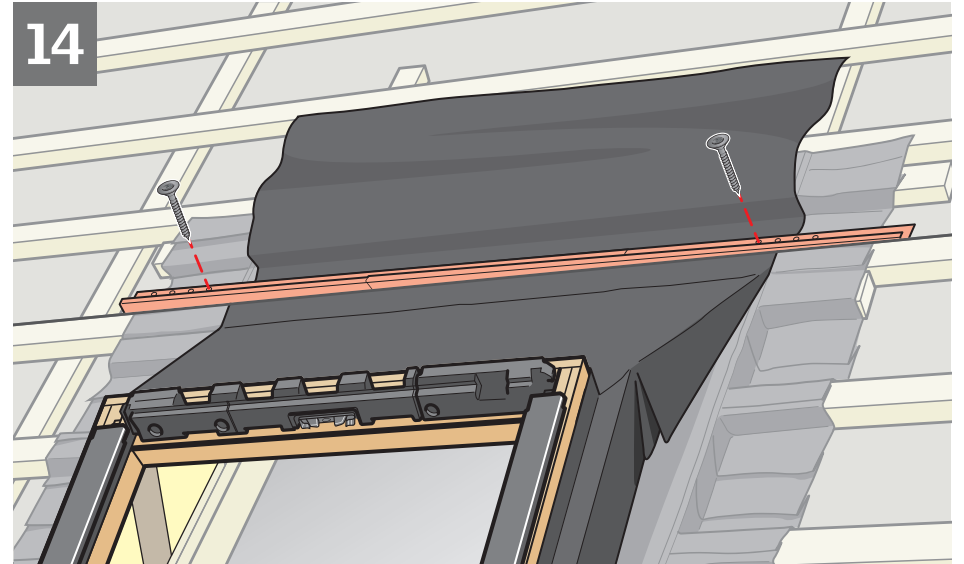
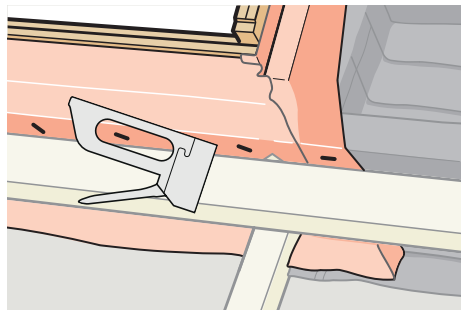
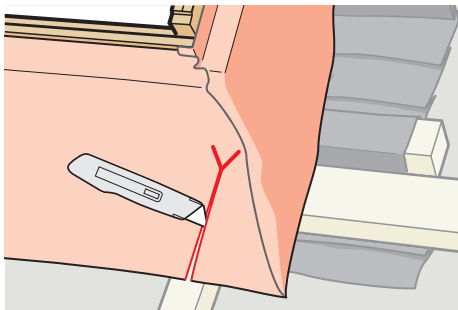
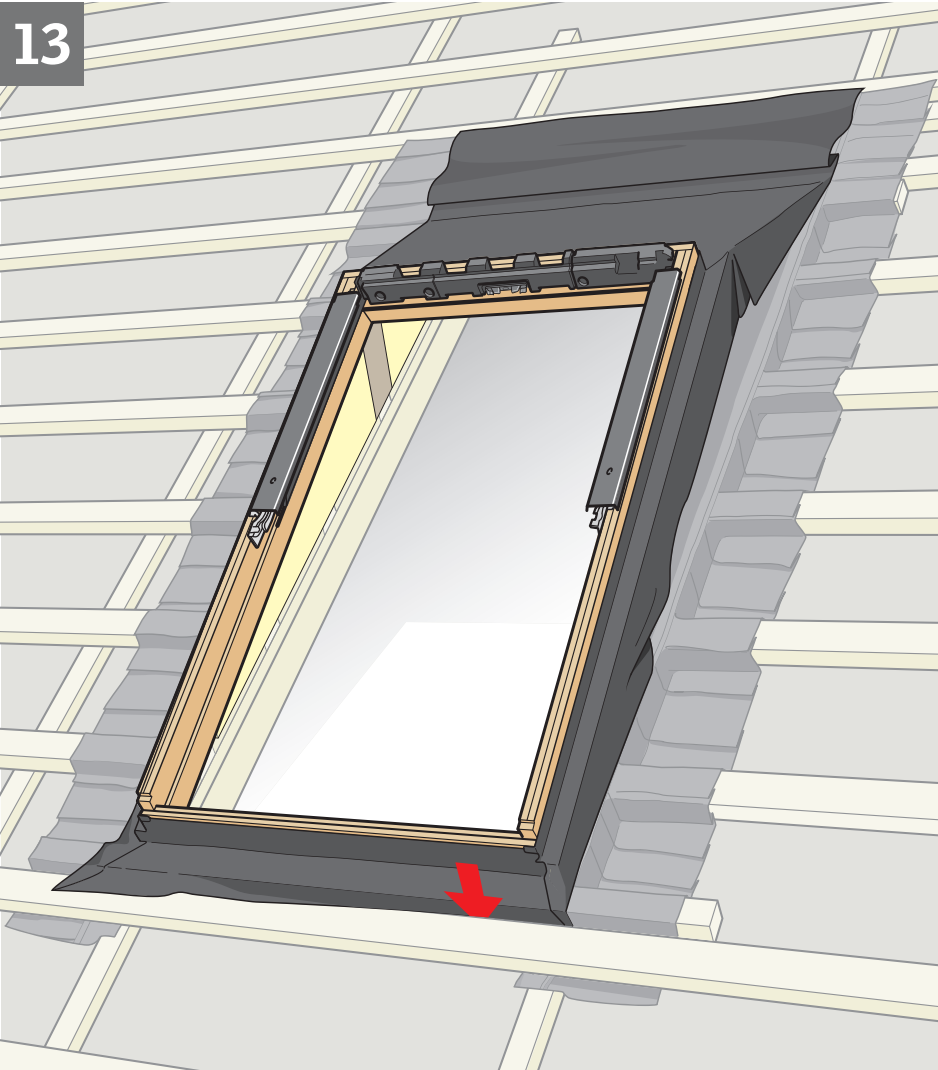

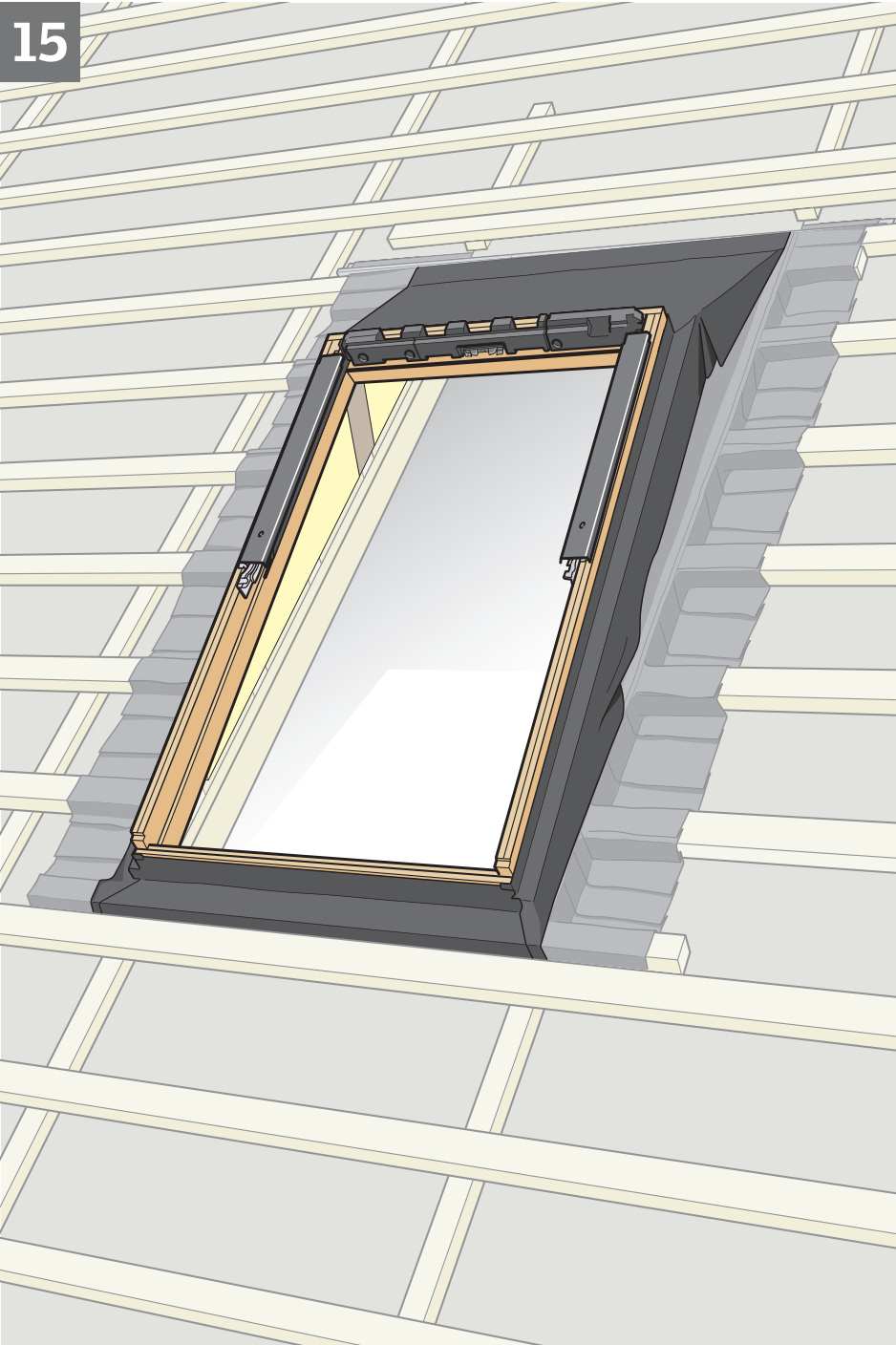

EAZ

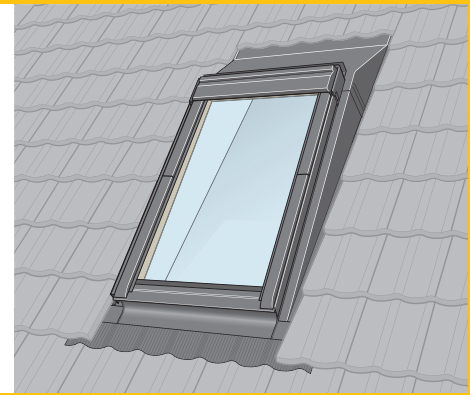
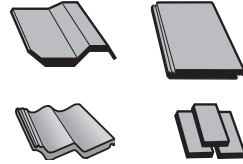

Pages
14-19

EAW

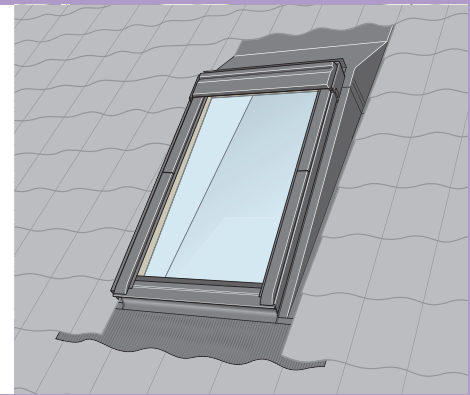
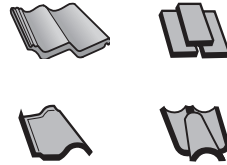

Pages
20-25

EAS

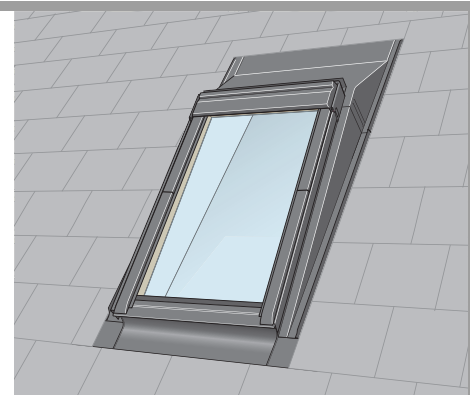
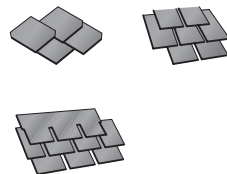

Pages
26-31

15 EAZ

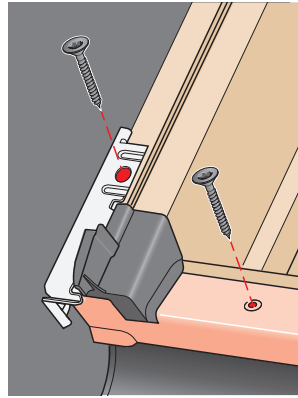
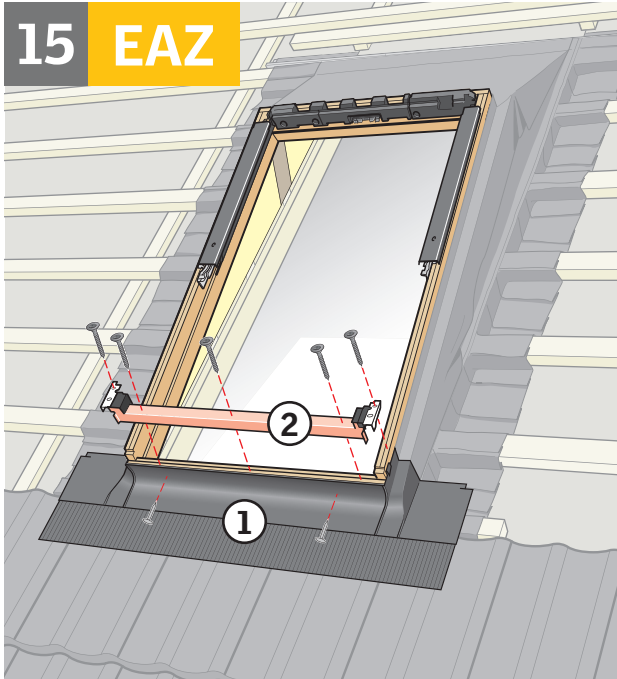

17

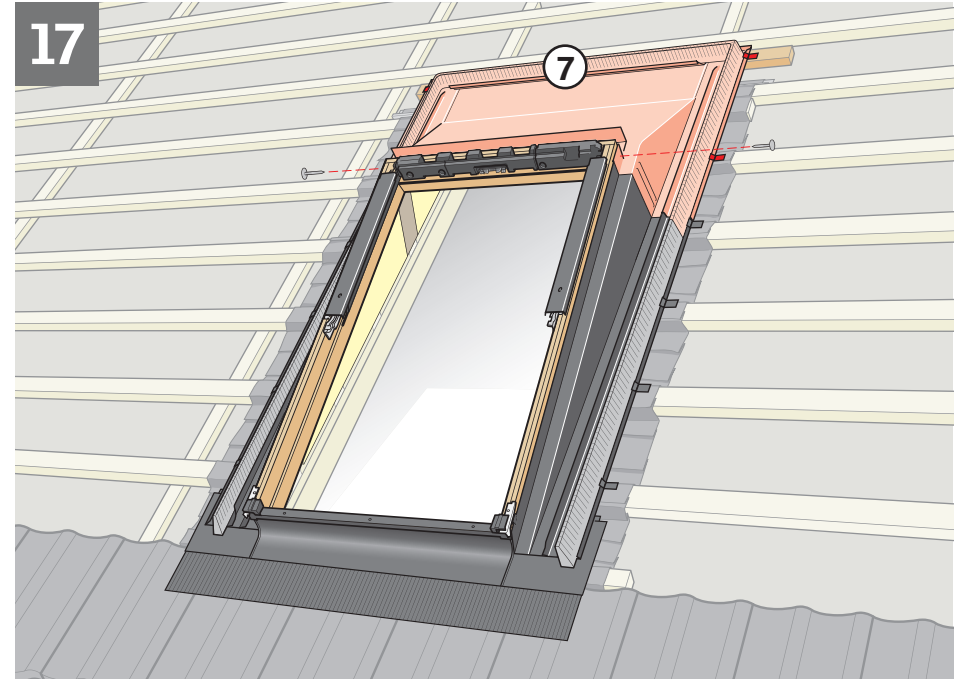

16

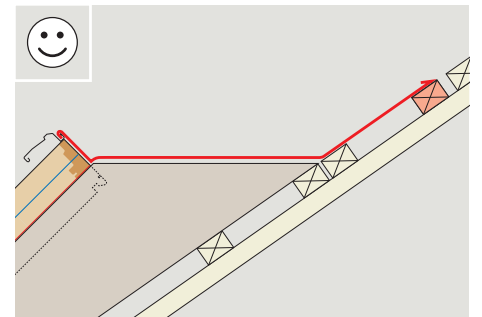
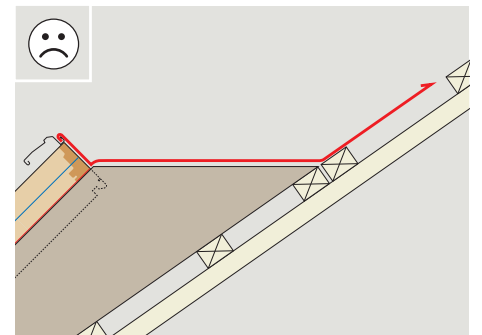
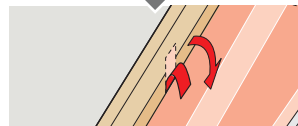
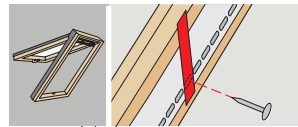
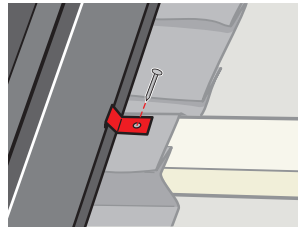
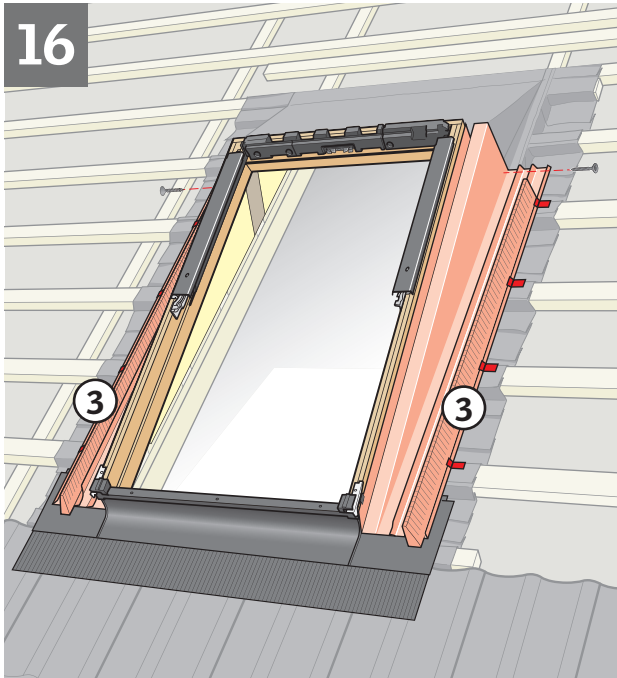

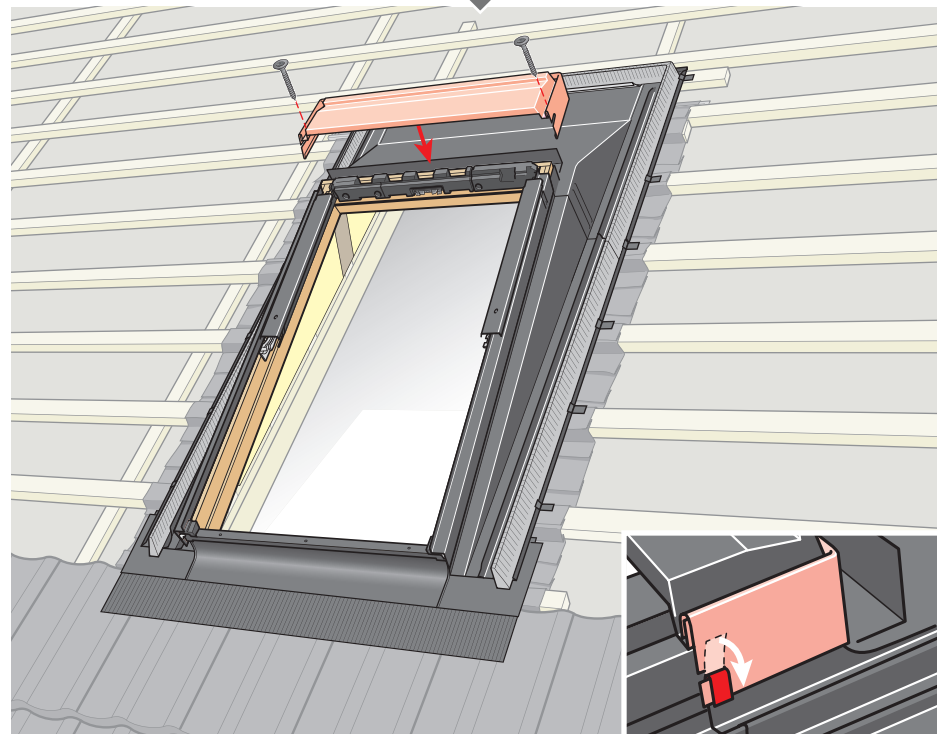
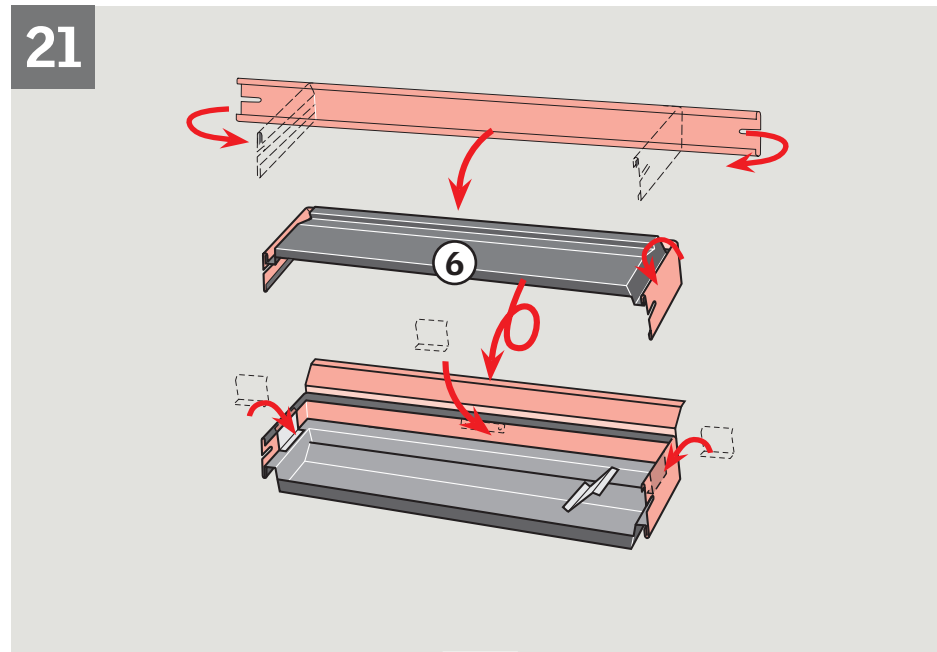
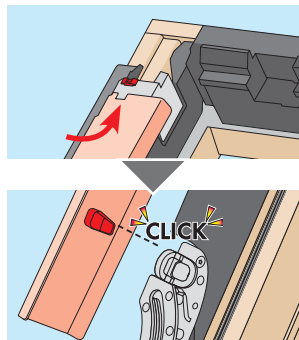
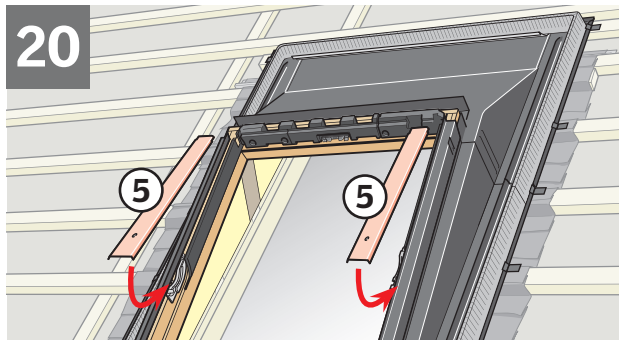
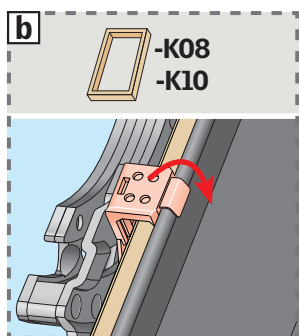
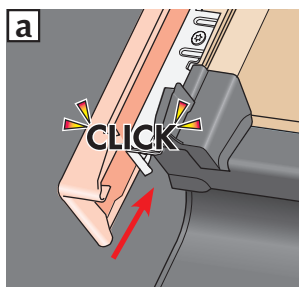
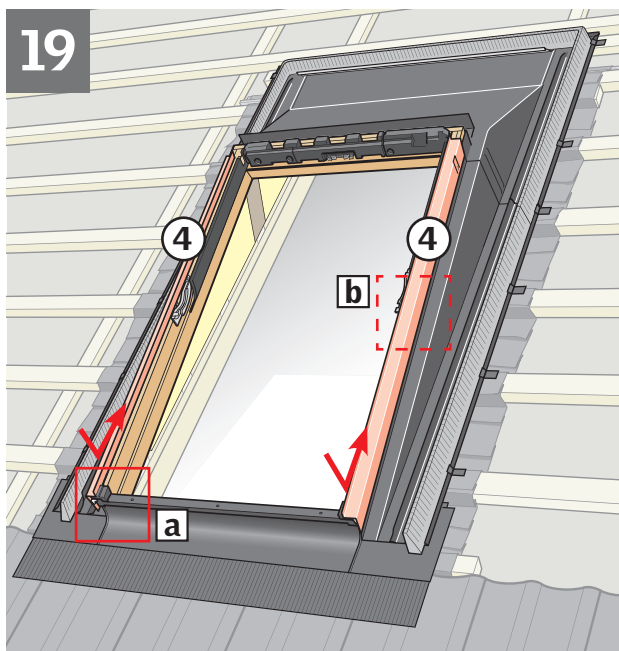
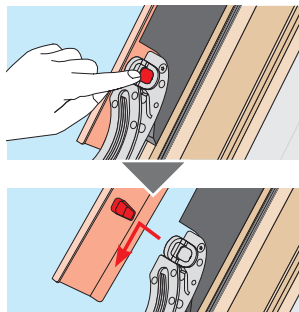
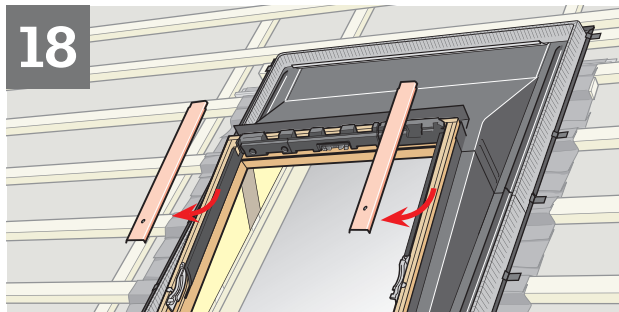

22

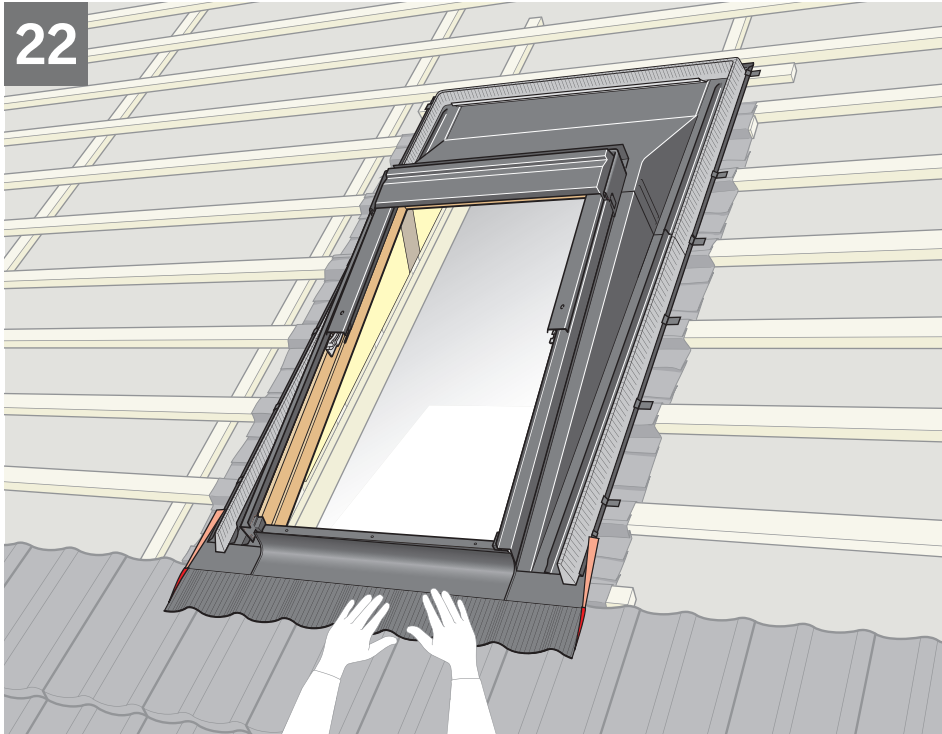

23

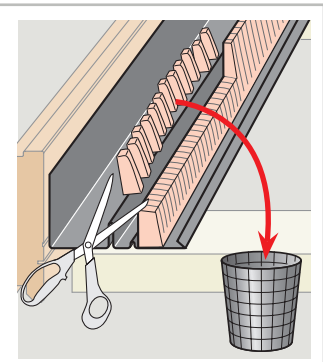
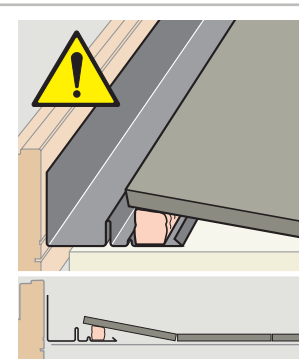
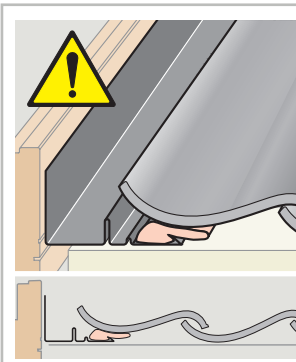
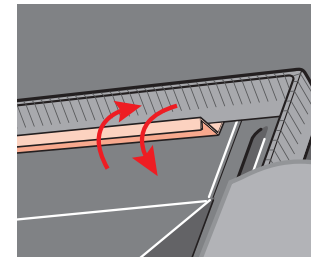
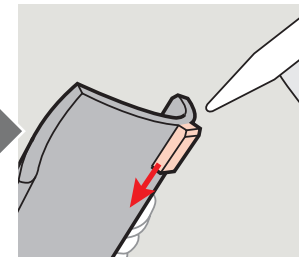
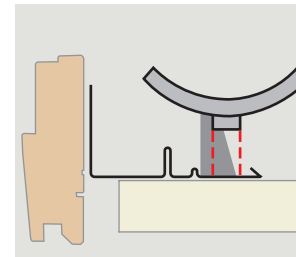
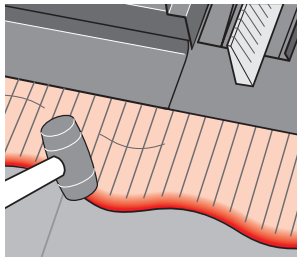
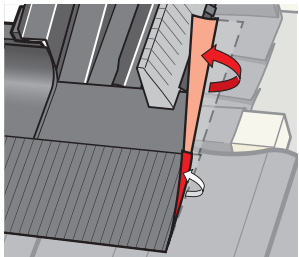
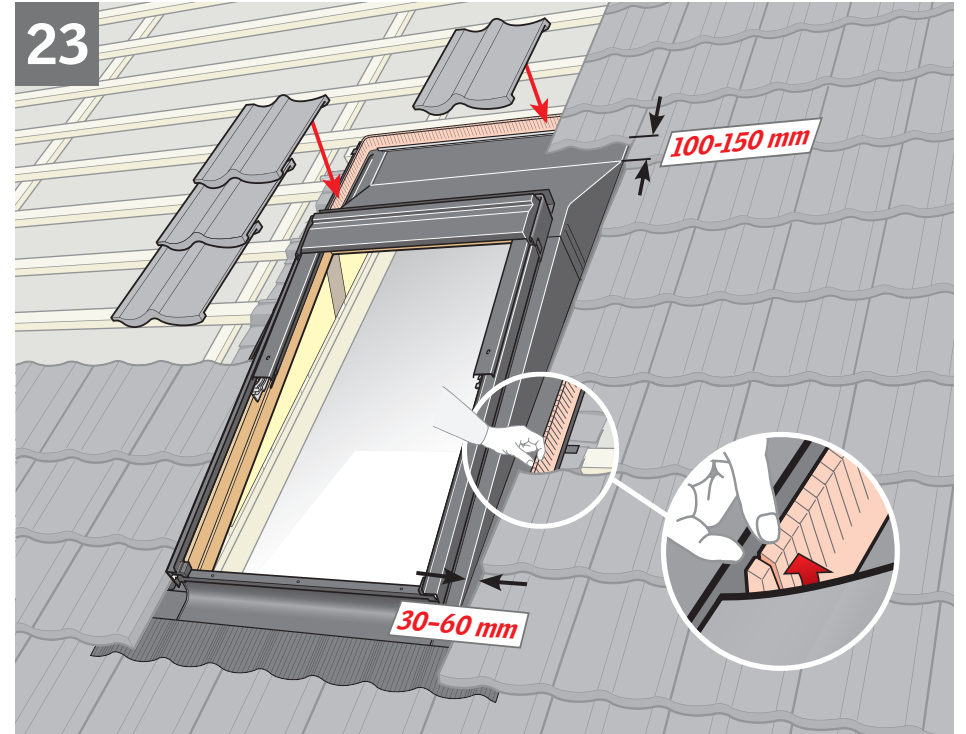

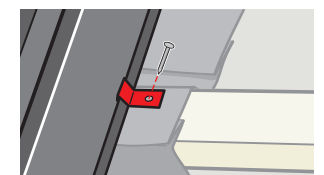
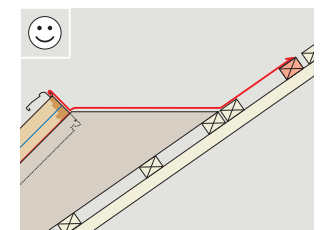
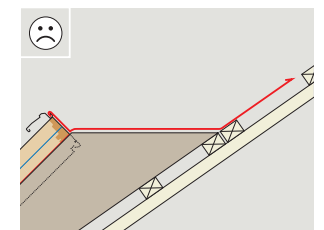
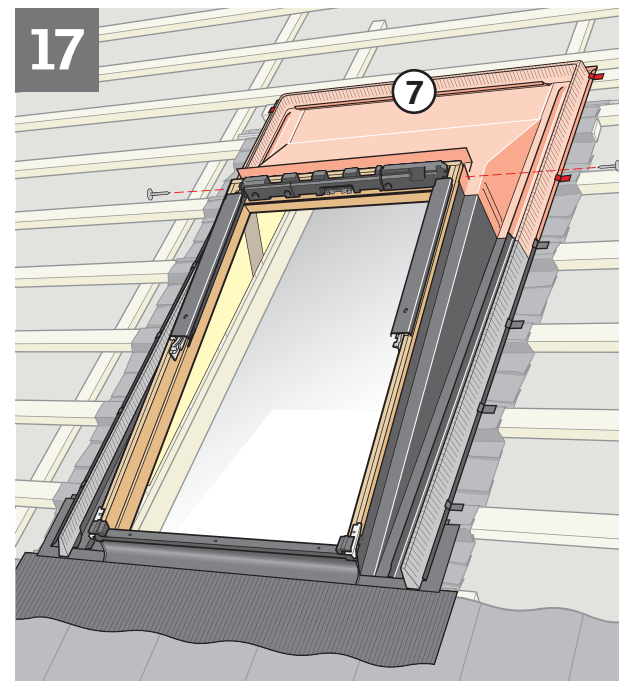
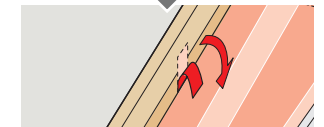
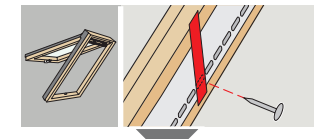
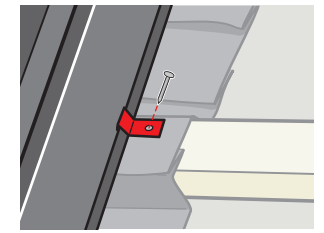
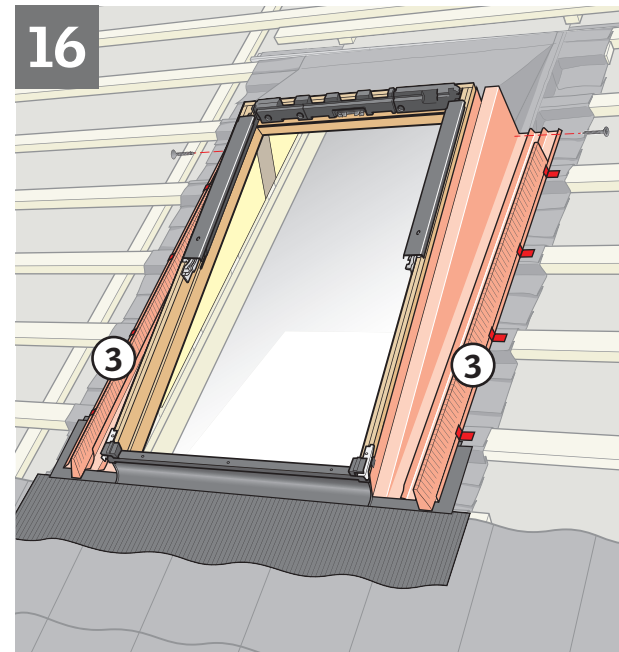
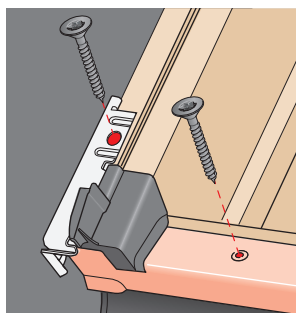
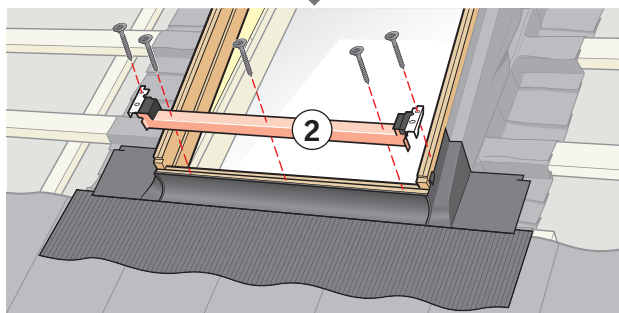
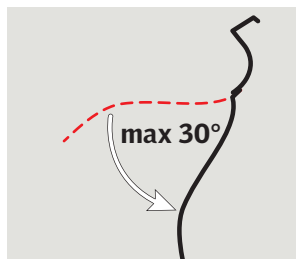
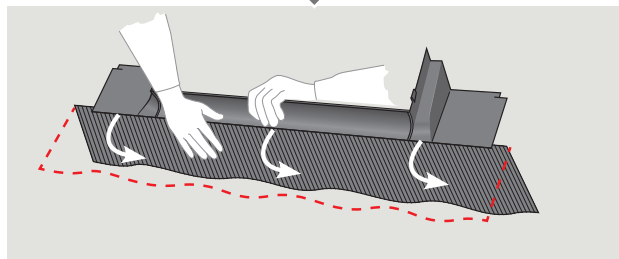
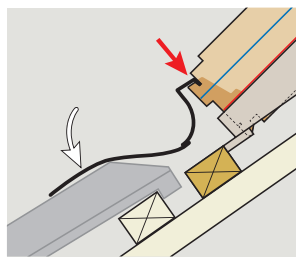
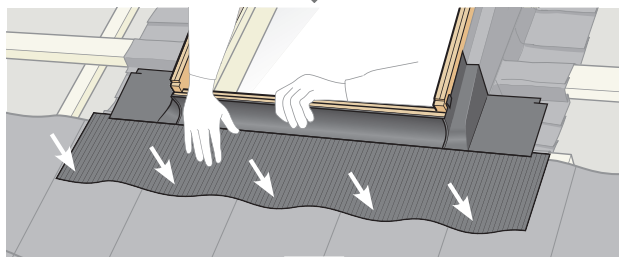
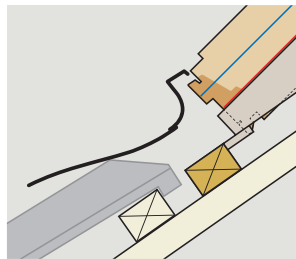
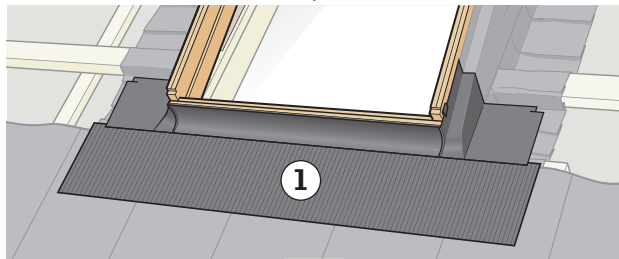
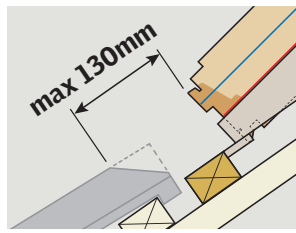
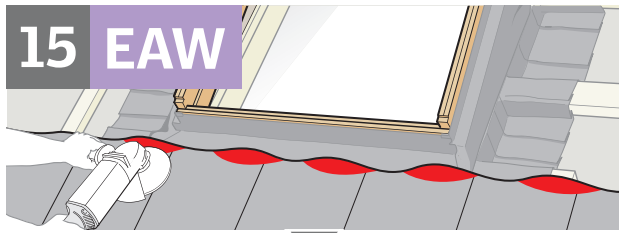

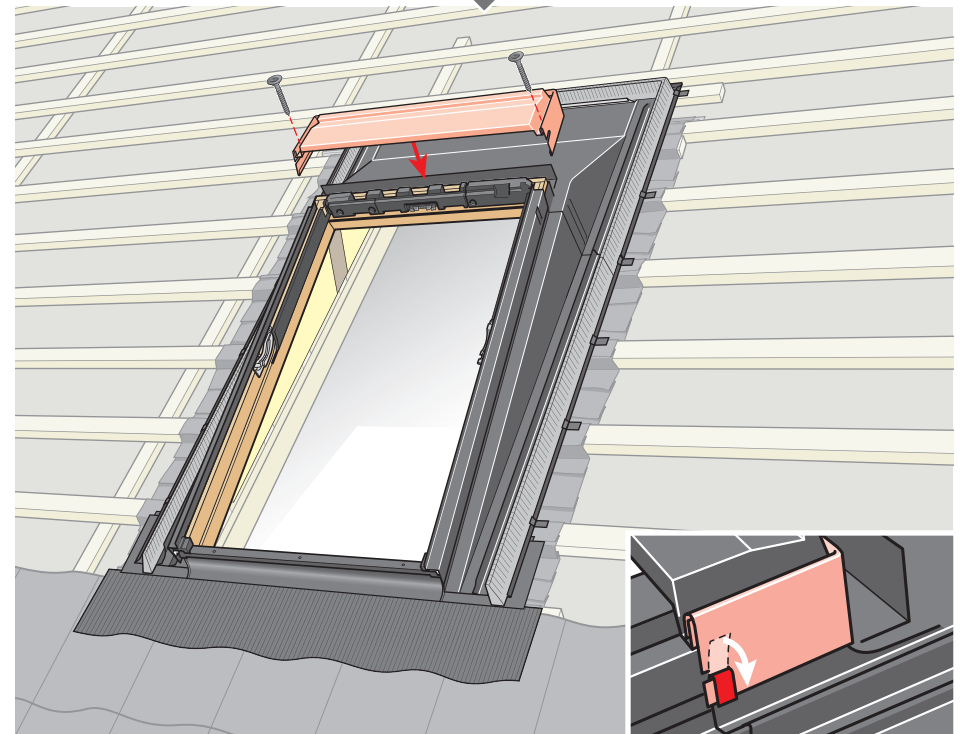
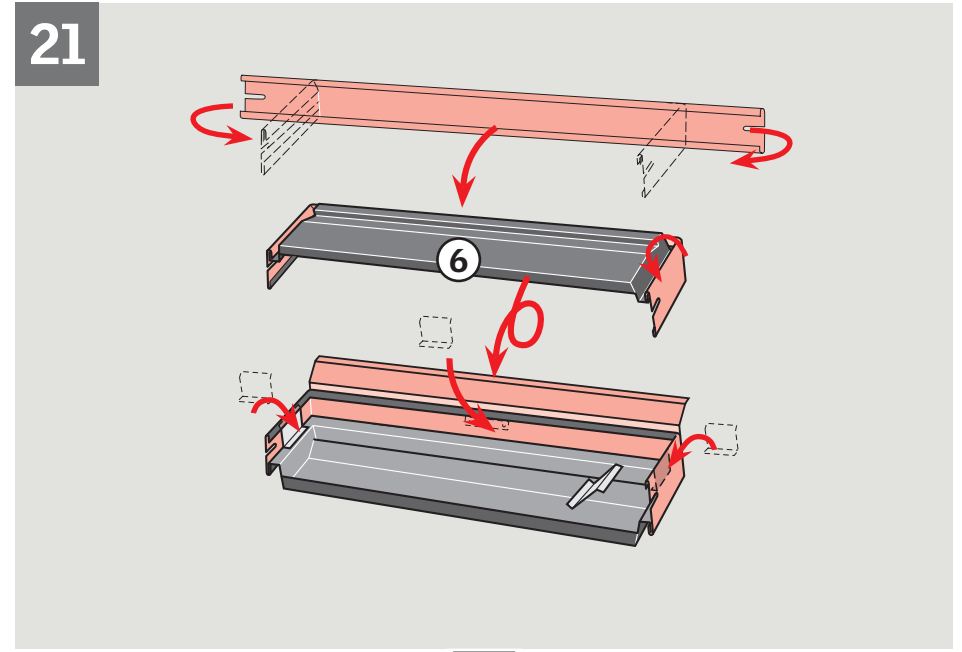
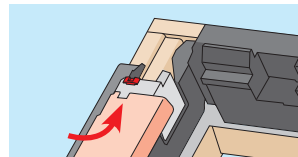
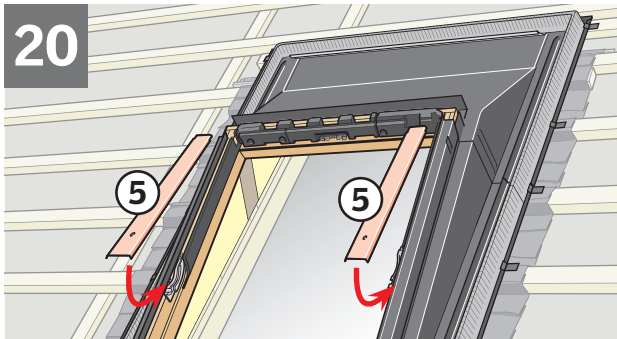
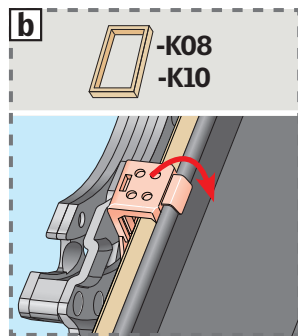
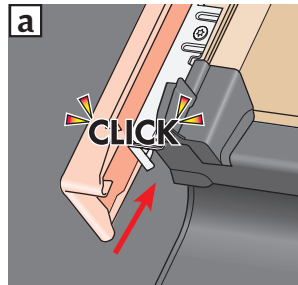
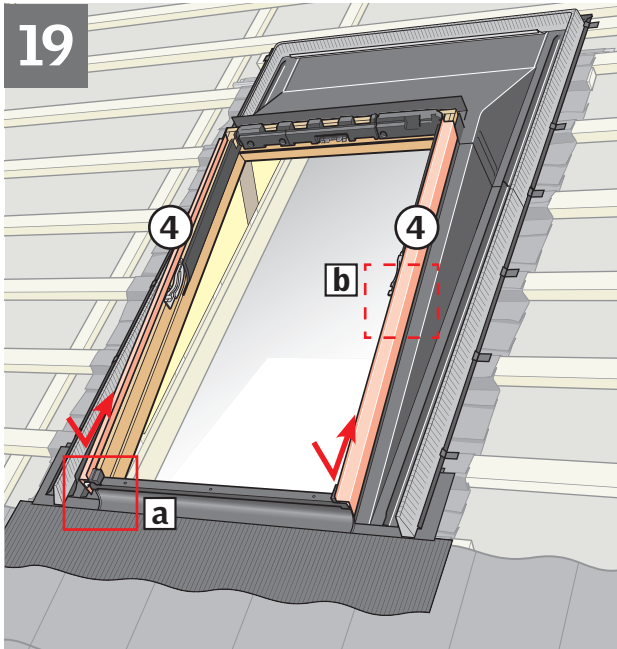
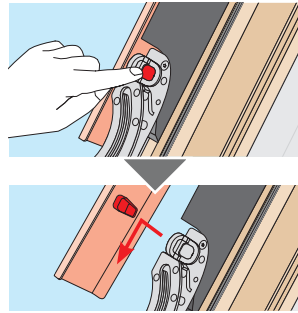
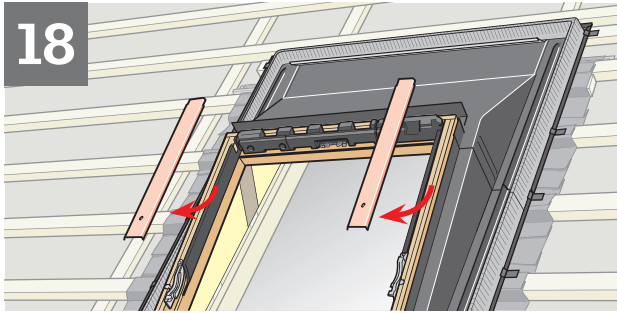

22

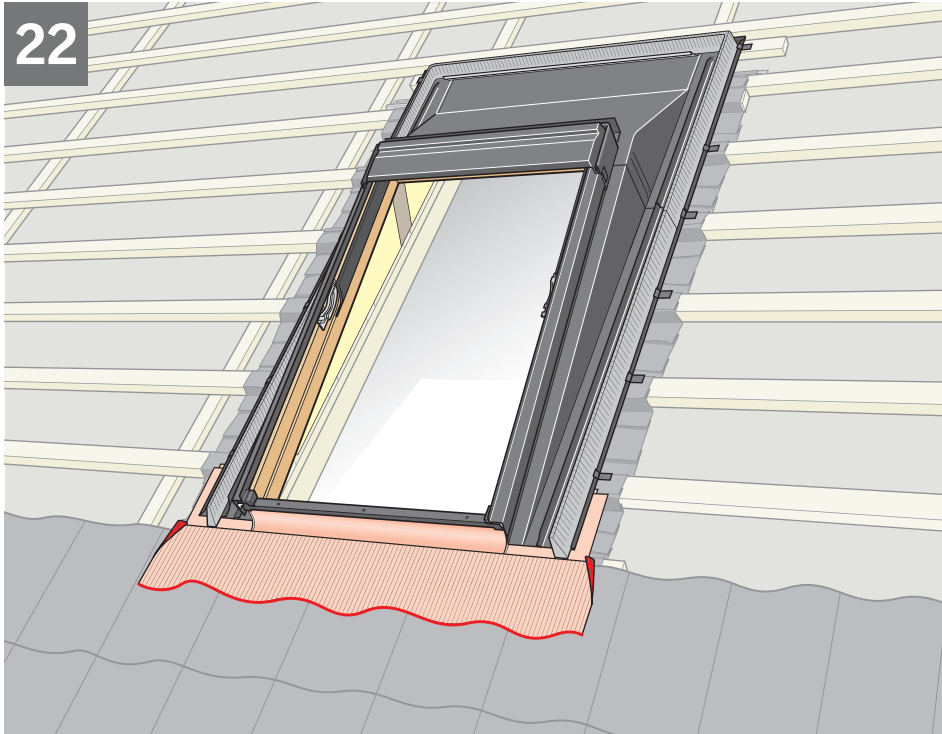

23

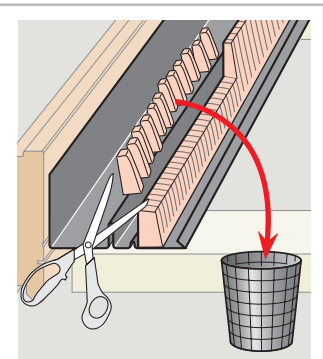
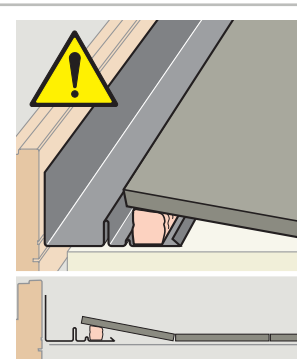
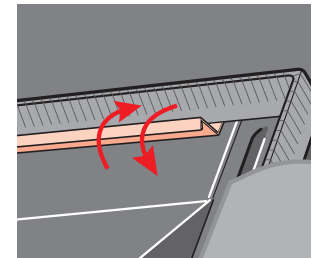
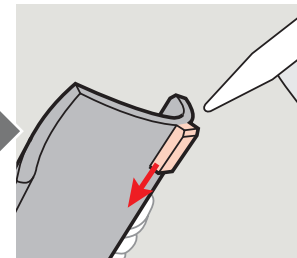
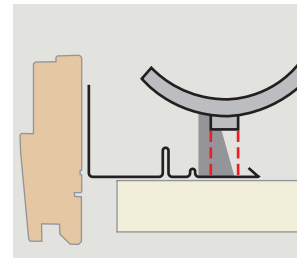
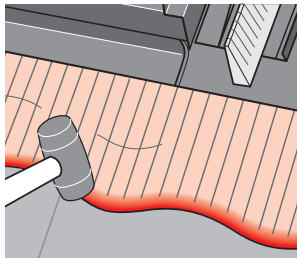
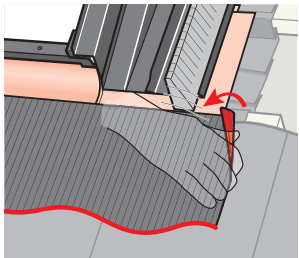
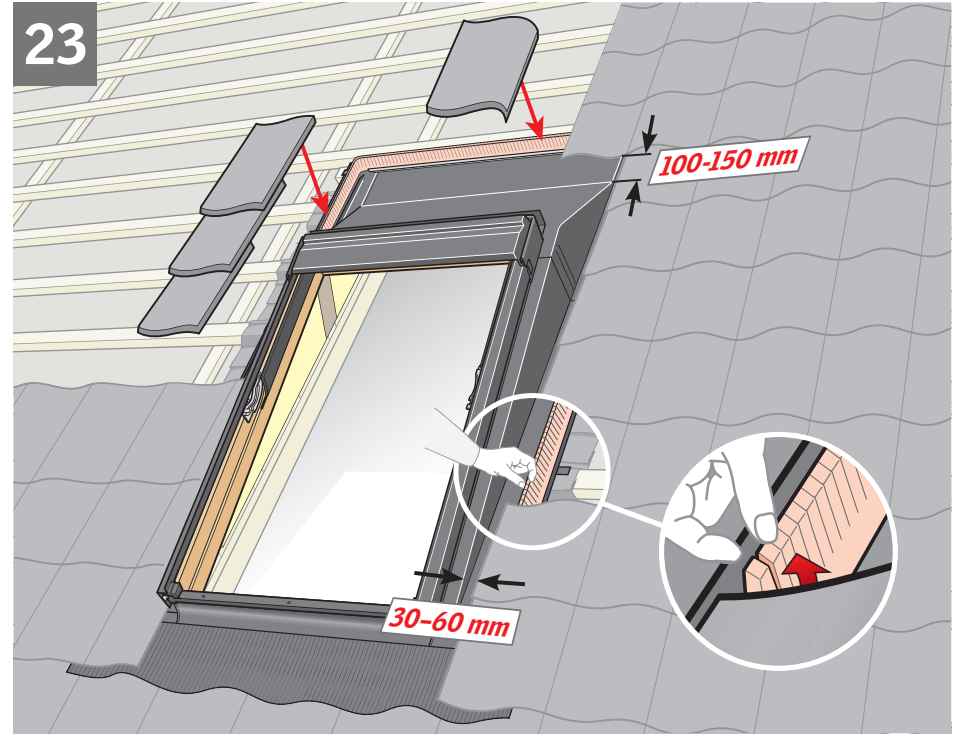

15 EAS

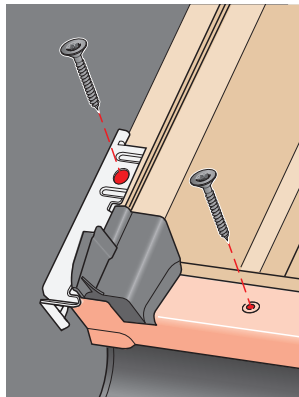
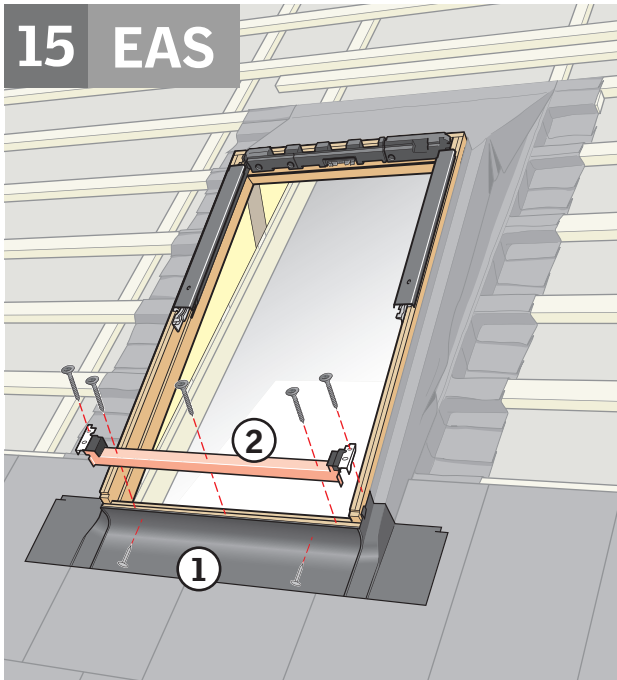

17

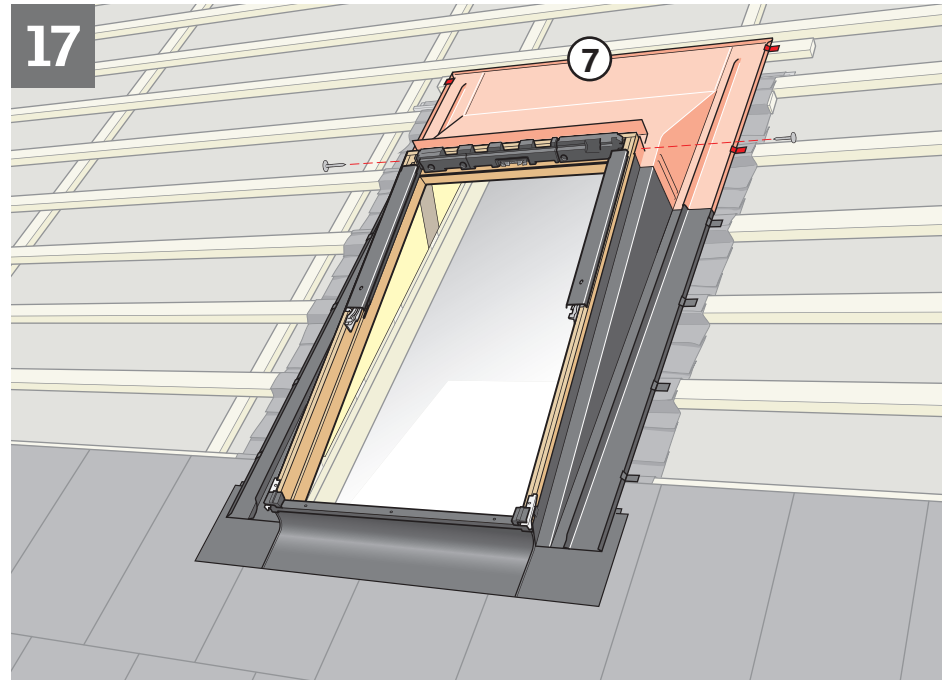

16

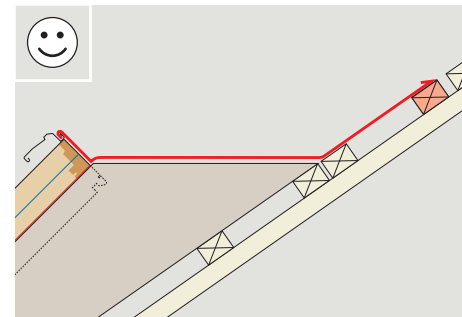
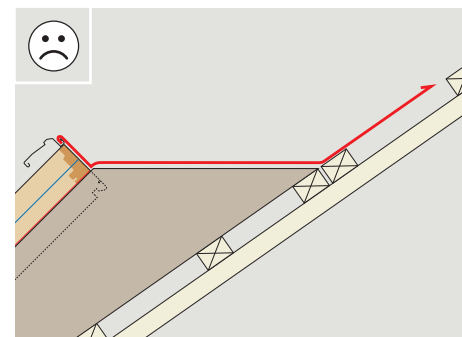
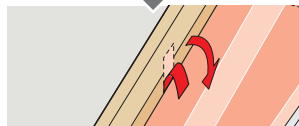
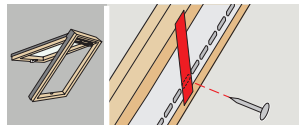
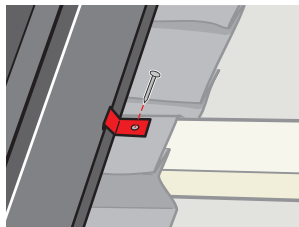
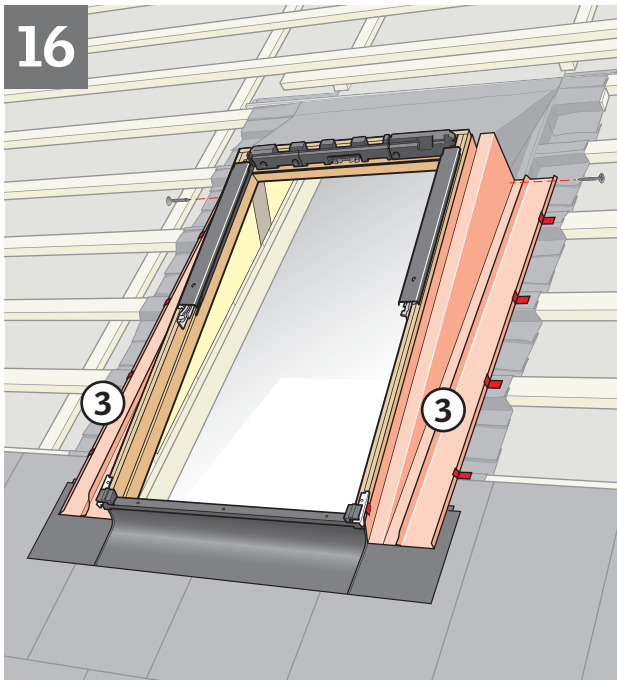

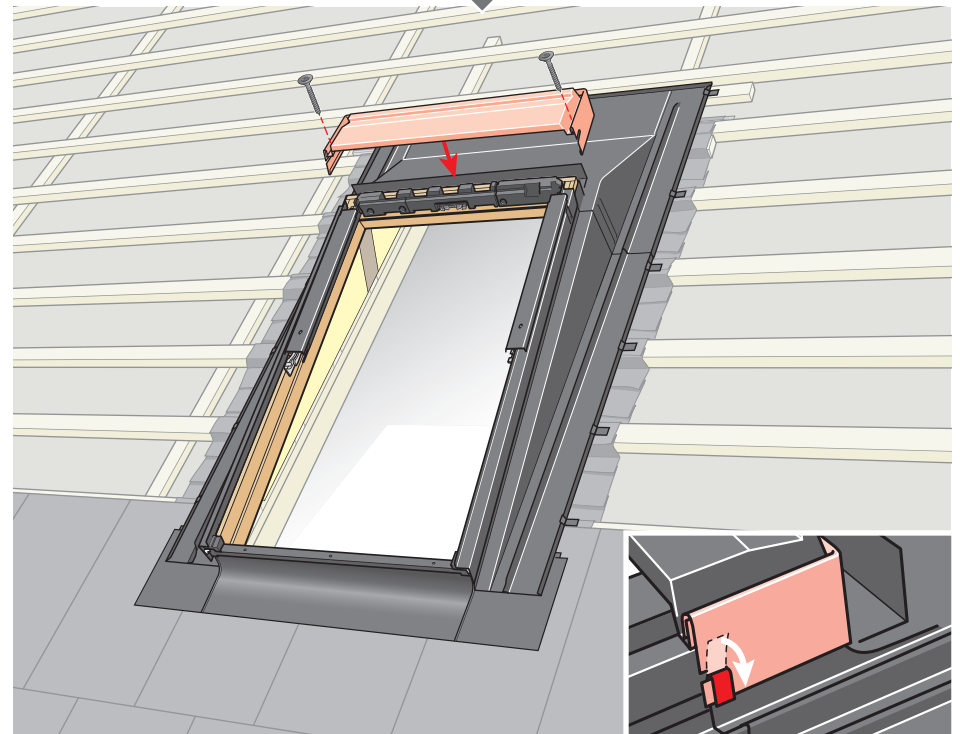
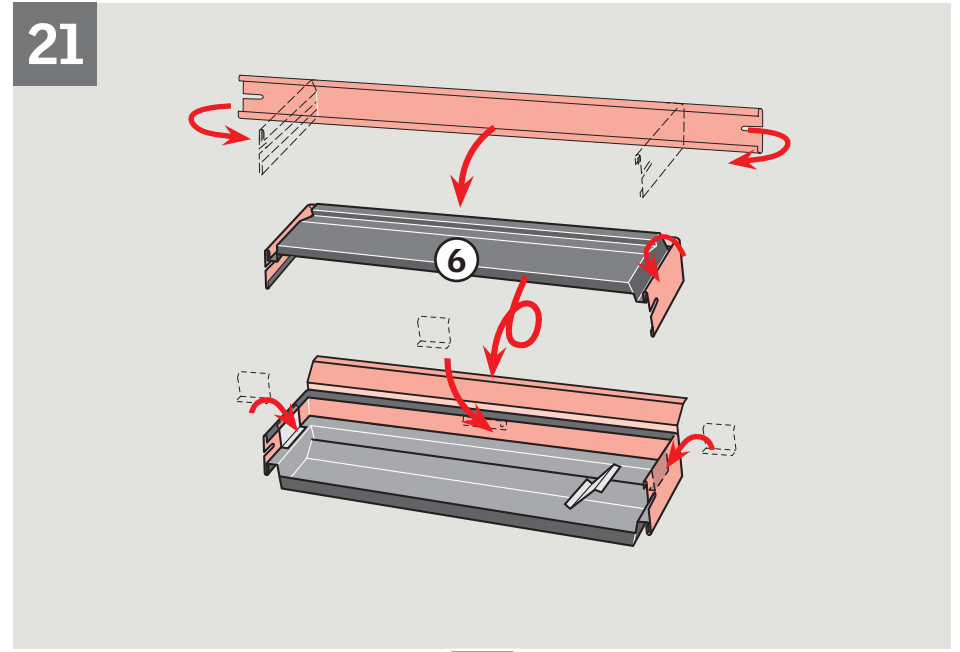
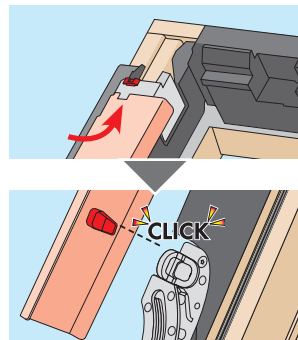
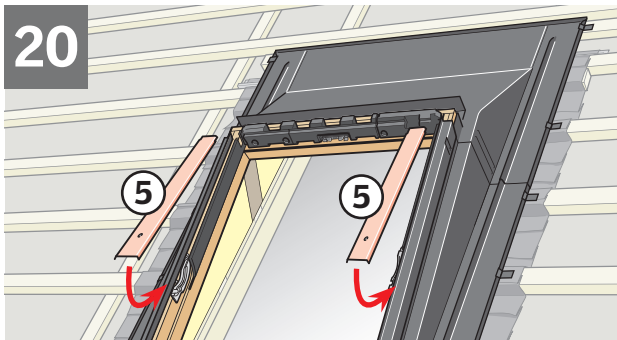
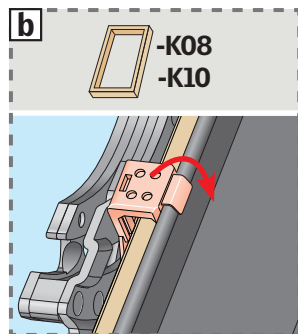
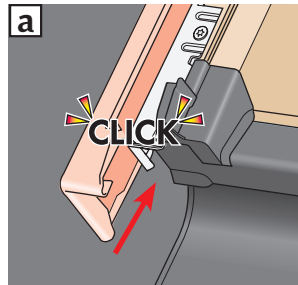
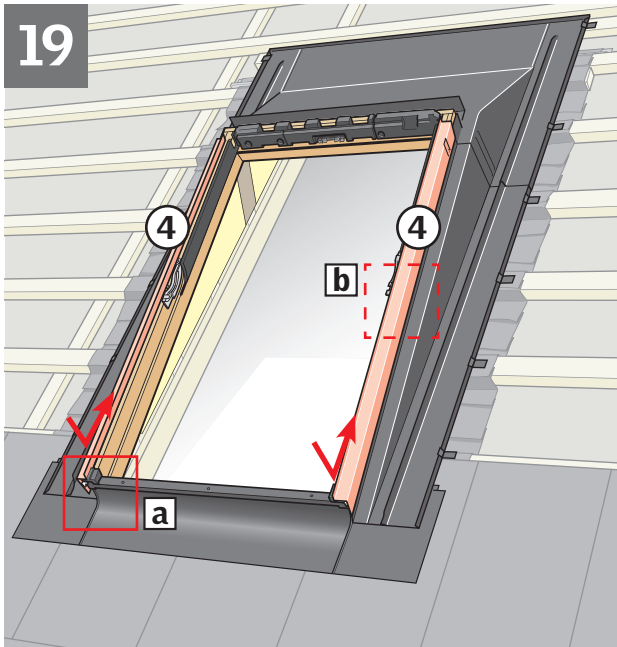
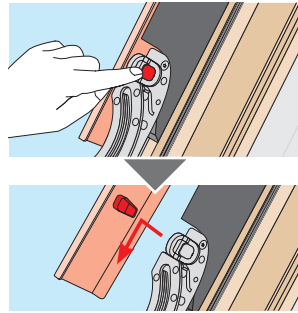
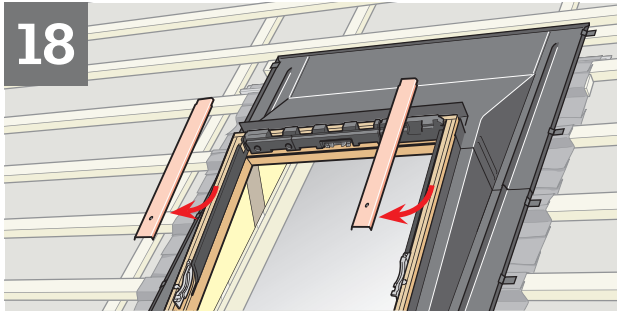

22

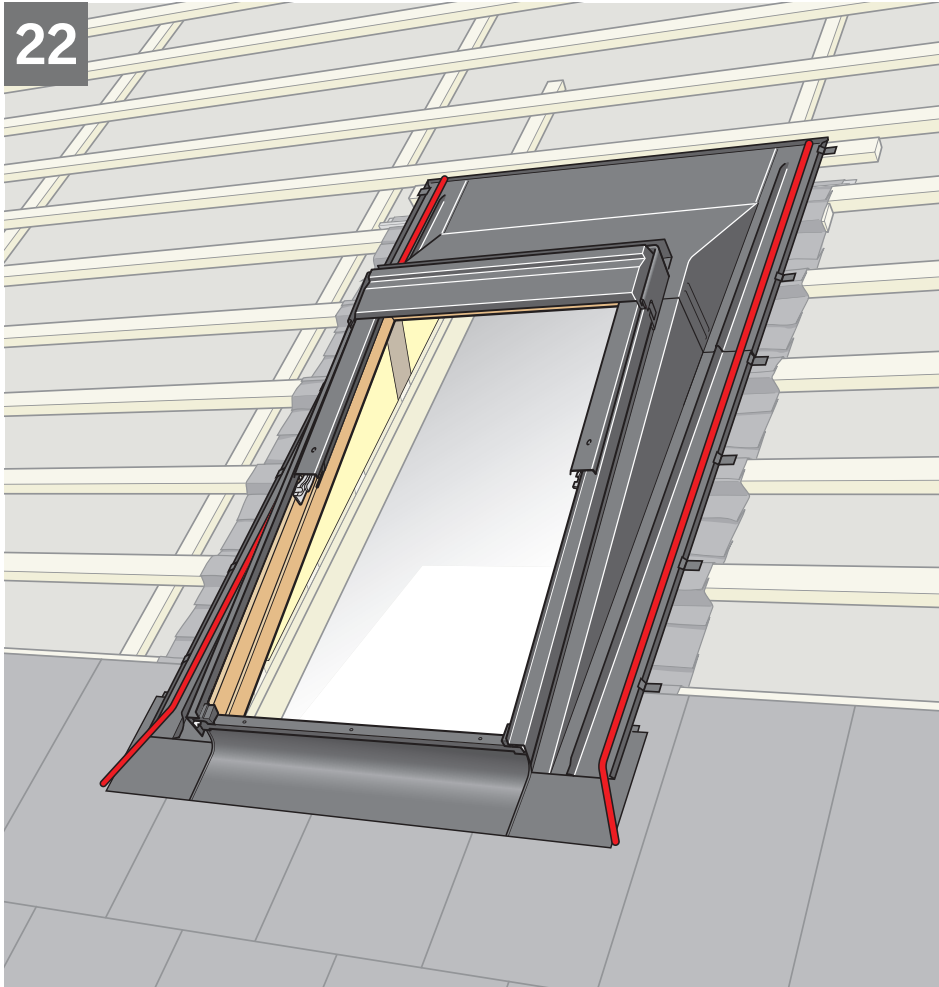

23

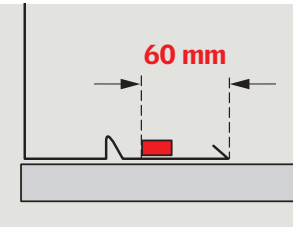
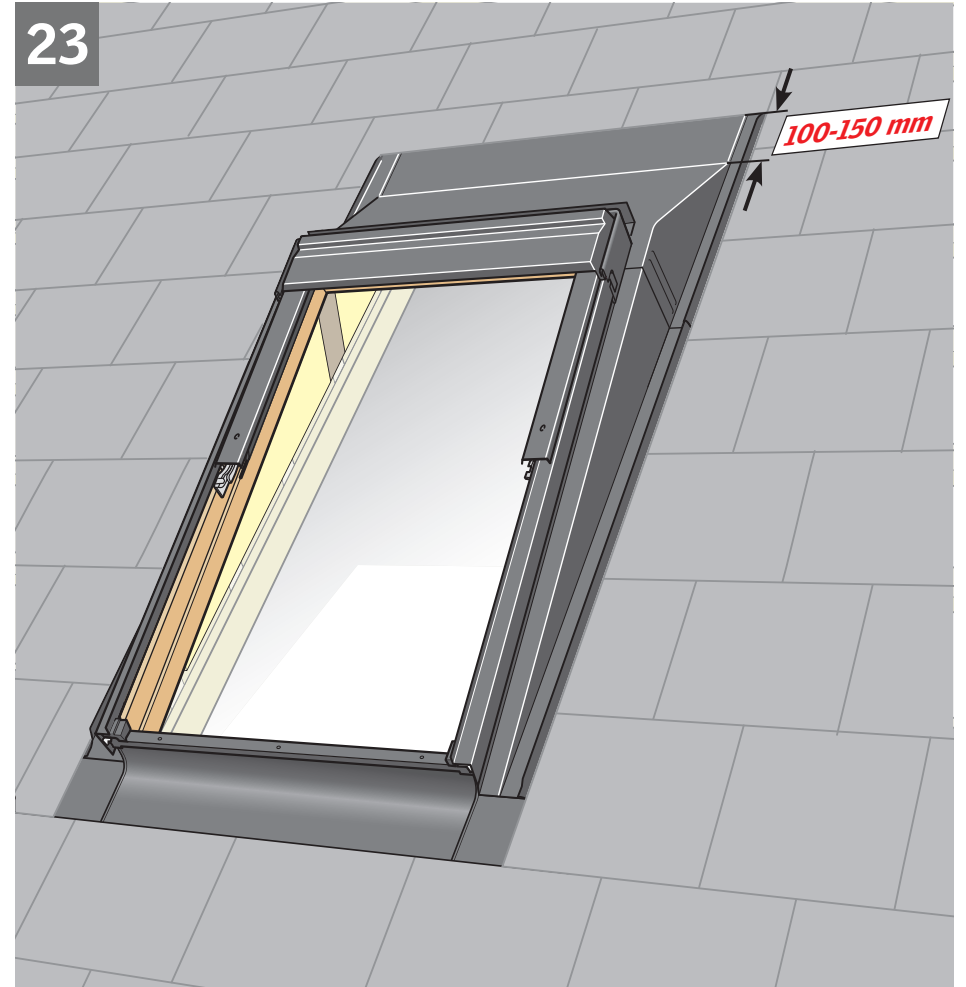

AR:	VELUX Argentina S.A. 348 4 639944	IE:	VELUX Company Ltd. 01 848 8775
AT:	VELUX Österreich GmbH 02245/32 3 50	IT:	VELUX Italia s.p.a. 045/6173666
AU:	VELUX Australia Pty. Ltd. 1300 859 856	JP:	VELUX-Japan Ltd. 0570-00-8145
BA:	VELUX Bosna i Hercegovina d.o.o. 033/626 493, 626 494	LT:	VELUX Lietuva, UAB (85) 270 91 01
BE:	VELUX Belgium (010) 42.09.09	LV:	VELUX Latvia SIA 67 27 77 33
BG:	ВЕЛУКС България ЕООД 02/955 99 30	NL:	VELUX Nederland B.V. 030 - 6 629 629
BY:	Унитарное предприятие "ВЕЛЮКС Мансардные Окна" (017) 329 20 89	NO:	VELUX Norge AS 22 51 06 00
CA:	VELUX Canada Inc. 1 800 88-VELUX (888-3589)	NZ:	VELUX New Zealand Ltd. 0800 650 445
CH:	VELUX Schweiz AG 062 289 44 45	PL:	VELUX Polska Sp. z o.o. (022) 33 77 000 / 33 77 070
CL:	VELUX Chile Limitada 2 953 6789	PT:	VELUX Portugal, Lda 21 880 00 60
CN:	VELUX (CHINA) CO. LTD. 0316-607 27 27	RO:	VELUX România S.R.L. 0-8008-83589
CZ:	VELUX Česká republika, s.r.o. 531 015 511	RS:	VELUX Srbija d.o.o. 011 20 57 500
DE:	VELUX Deutschland GmbH 040 / 54 70 70	RU:	ЗАО ВЕЛЮКС (495) 640 87 20
DK:	VELUX Danmark A/S 45 16 45 16	SE:	VELUX Svenska AB 042/20 83 80
EE:	VELUX Eesti OÜ 621 7790	SI:	VELUX Slovenija d.o.o. 01 724 68 68
ES:	VELUX Spain, S.A. 91 509 71 00	SK:	VELUX Slovensko, s.r.o. (02) 33 000 555
FI:	VELUX Suomi Oy 0207 290 800	TR:	VELUX Çatı Pencereleri Ticaret Limited Şirketi 0 216 302 54 10
FR:	VELUX France 0821 02 15 15 0,119€ TTC/min	UA:	ТОВ "ВЕЛЮКС Україна" (044) 2916070
GB:	VELUX Company Ltd. 01592 778 225	US:	VELUX America LLC 1-800-88-VELUX
HR:	VELUX Hrvatska d.o.o. 01/5555 444		
HU:	VELUX Magyarország Kft. (06/1) 436-0601		