

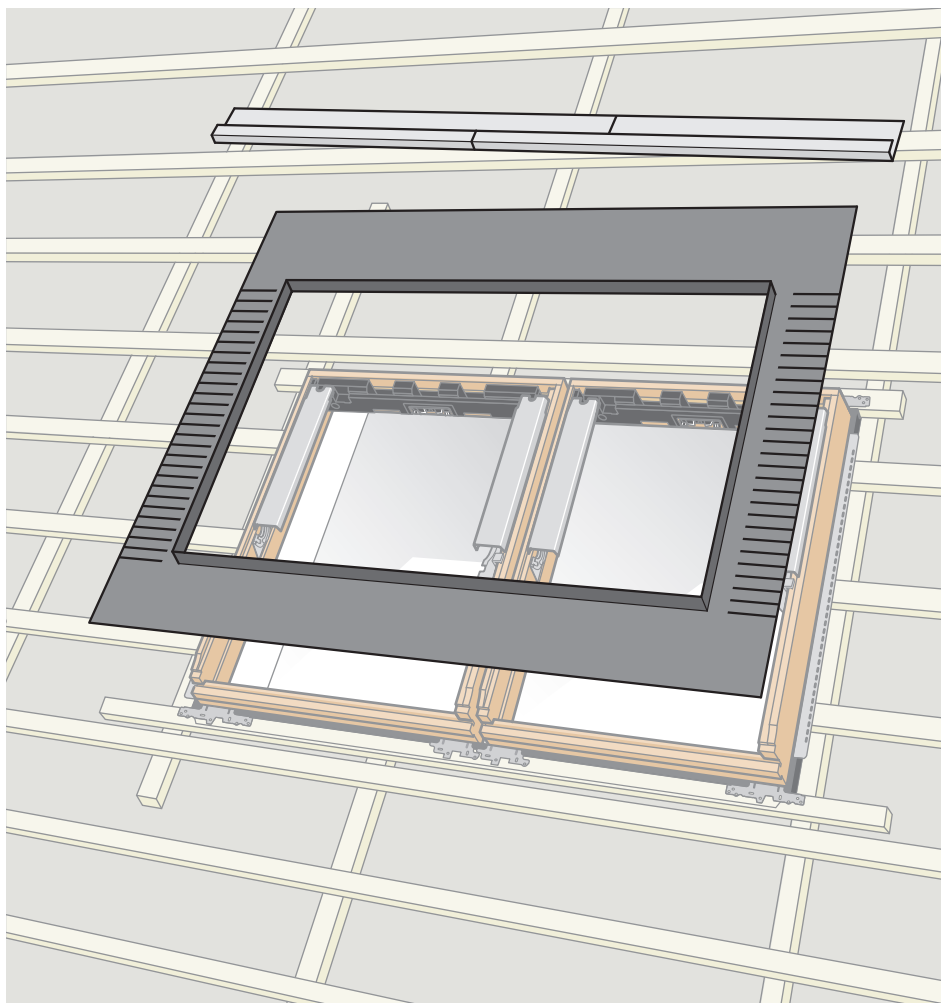

**VELUX®**

# BFX 1010

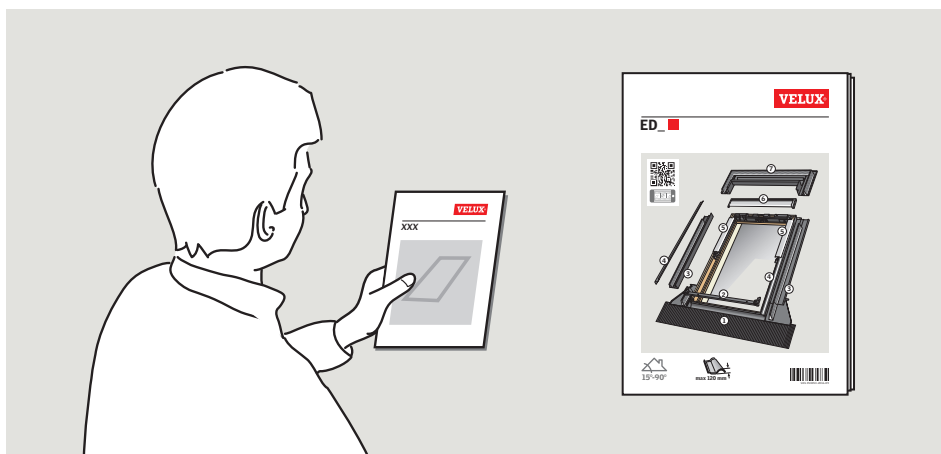
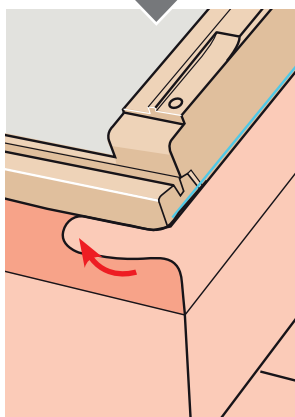
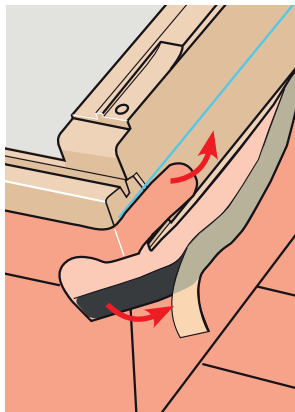
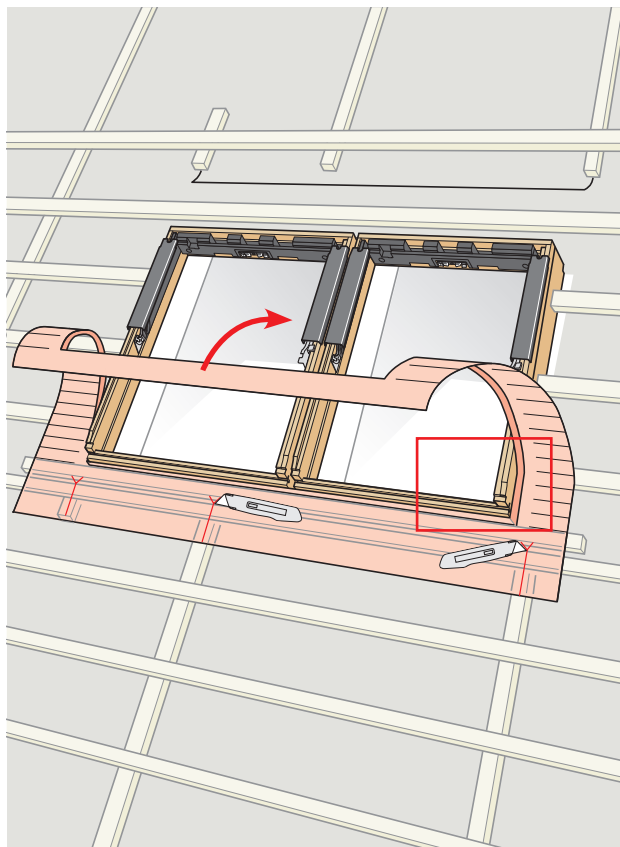

VAS 453300-2025-07



 	
EN 13859-1:2014 Notified body: 0338	
BFX	
Flexible sheet for underlays for roofs	
Reaction to fire:  Resistance to water penetration: - before artificial ageing: - after artificial ageing:  Tensile strength in longitudinal direction: - before artificial ageing: - after artificial ageing:  Tensile strength in transverse direction: - before artificial ageing: - after artificial ageing:  Elongation in longitudinal direction: - before artificial ageing: - after artificial ageing:  Elongation in transverse direction: - before artificial ageing: - after artificial ageing:  Tear resistance: - longitudinal direction: - transverse direction:  Flexibility at low temperature (pliability):  Artificial ageing behavior, concerning: - resistance to water penetration: - tensile strength:	Class E   Class W1 Class W1  200 N/50 mm 120 N/50 mm  200 N/50 mm 120 N/50 mm  NPD NPD  NPD NPD  NPD NPD  NPD NPD
VELUX A/S Ådalsvej 99 DK-2970 Hørsholm <a href="http://www.velux.com/ce">www.velux.com/ce</a>	



[www.velux.com](http://www.velux.com)

