

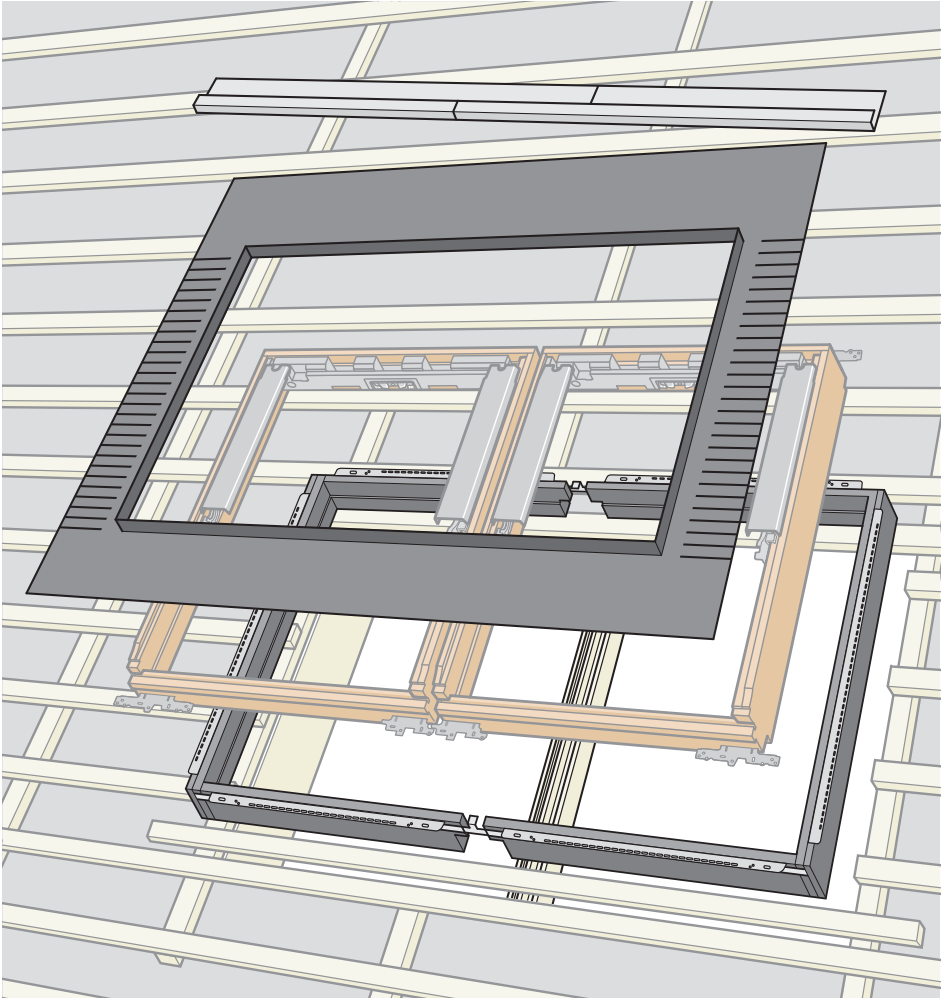

BDX 2011 ■

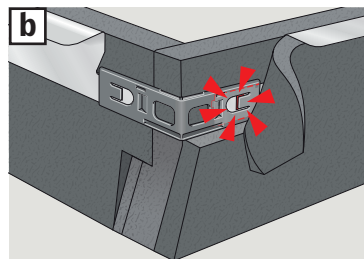

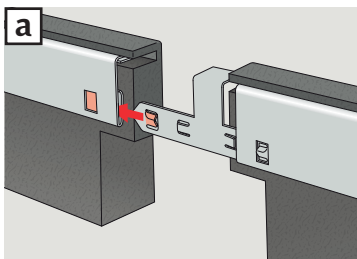
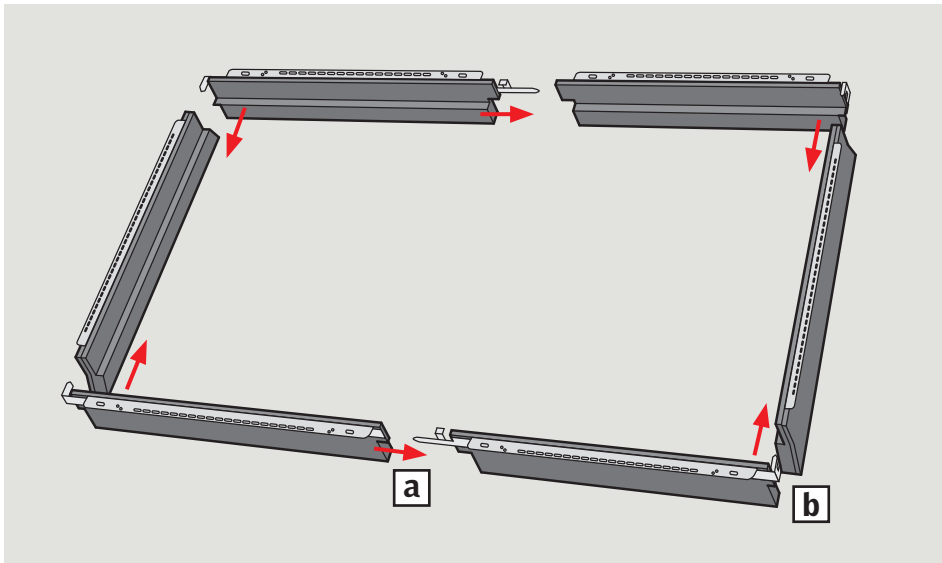

 13	
EN 13859-1:2014 Notified body: 0338	
BFX	
Flexible sheet for underlays for roofs	
Reaction to fire:	Class E
Resistance to water penetration:	
- before artificial ageing:	Class W1
- after artificial ageing:	Class W1
Tensile strength in longitudinal direction:	
- before artificial ageing:	200 N/50 mm
- after artificial ageing:	120 N/50 mm
Tensile strength in transverse direction:	
- before artificial ageing:	200 N/50 mm
- after artificial ageing:	120 N/50 mm
VELUX A/S Ådalsvej 99 DK-2970 Hørsholm www.velux.com/ce	

 13	
EN 16069:2012+A1:2015 Notified body: 0761, 1004	
BDX	
Thermal insulation product for buildings	
Reaction to fire:	Class E
Thermal conductivity:	0,039 W/(mK)
VELUX A/S Ådalsvej 99 DK-2970 Hørsholm www.velux.com/ce	



www.velux.com

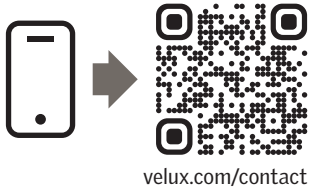

INSTALLATION INSTRUCTIONS FOR BDx 2011. ©2012, 2025 VELUX GROUP. ®VELUX AND THE VELUX LOGO ARE REGISTERED TRADEMARKS USED UNDER LICENSE BY THE VELUX GROUP