

JL/JK

VELUX®

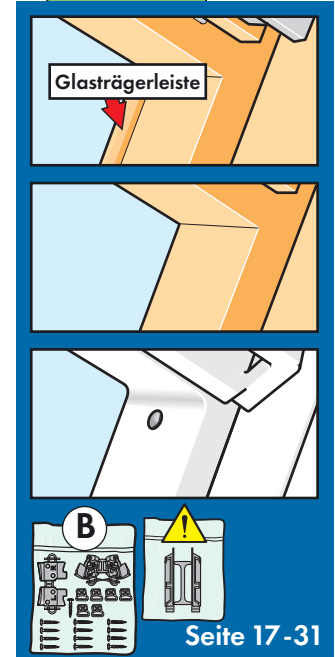

451459

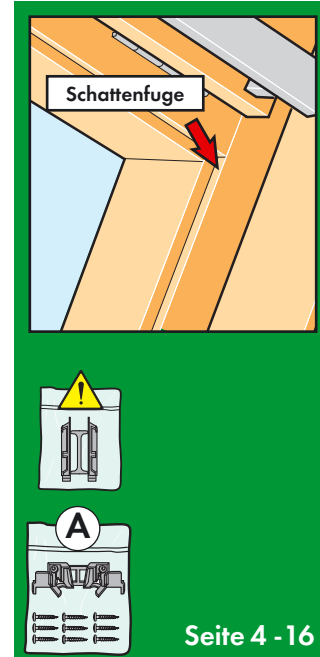
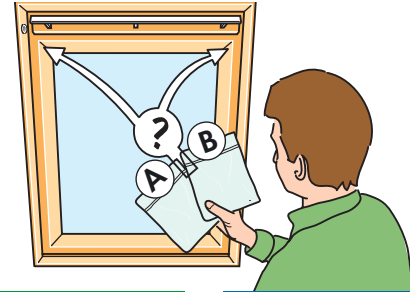
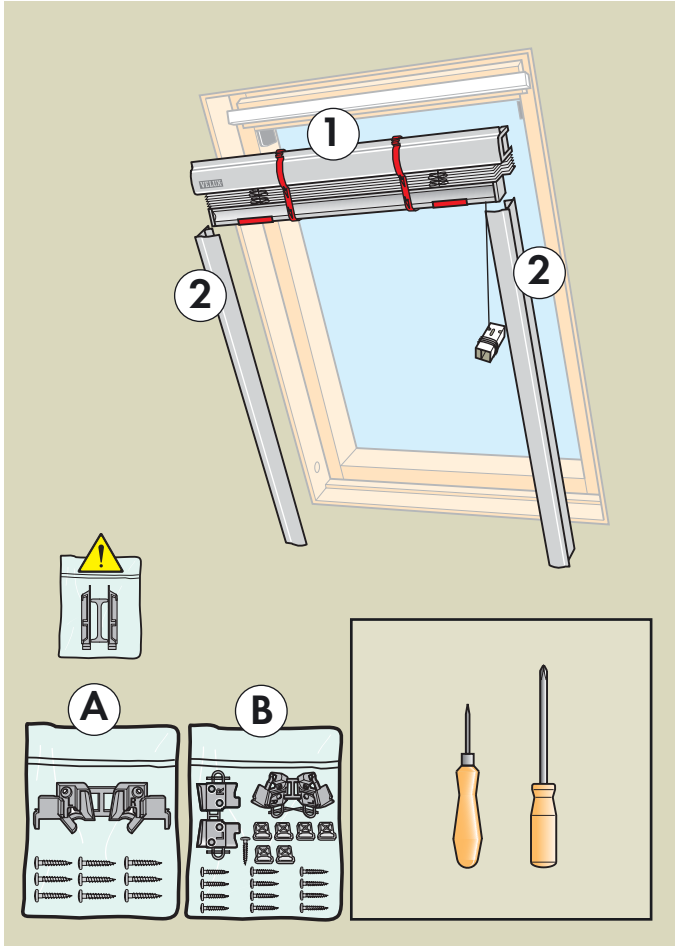

Montage in Holzfenster mit Schattenfuge

Achtung: Ihr Fenster wurde **serienmäßig mit Zubehörträgern** ausgerüstet.

Sollten Sie keine Träger mehr im Fenster haben, **müssen** Sie neue bestellen. Bestellnummer: 941400
Die mitgelieferten Träger passen nicht zu Ihrem Fenster.

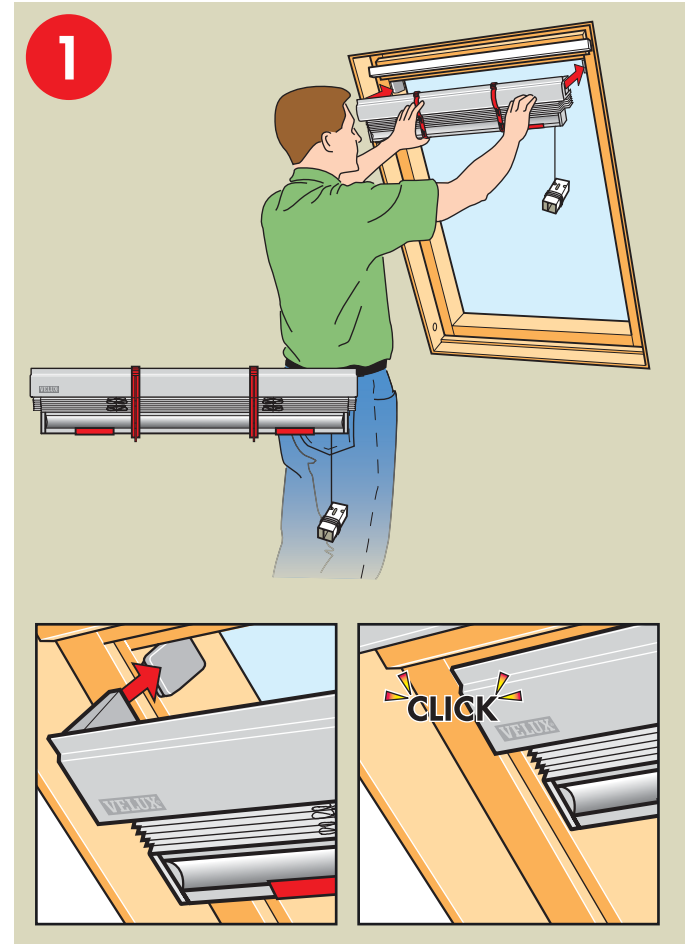
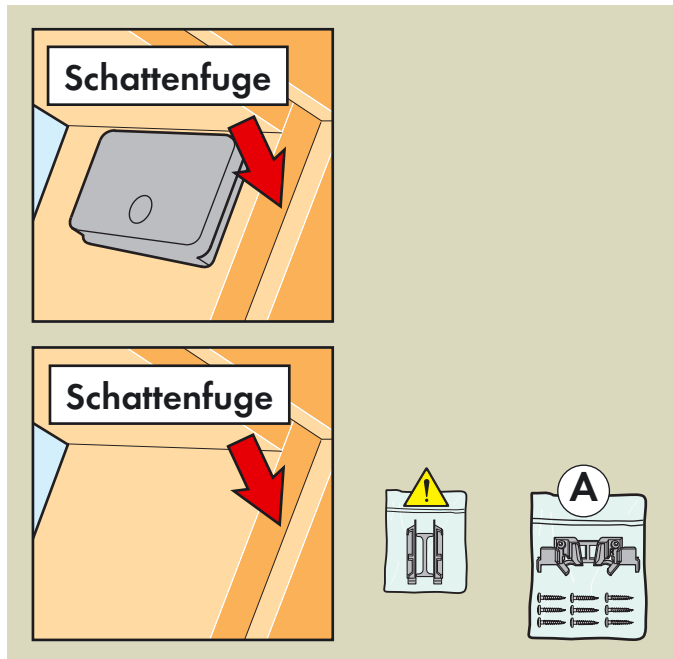

2

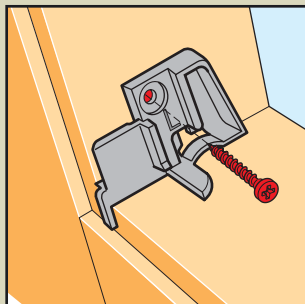
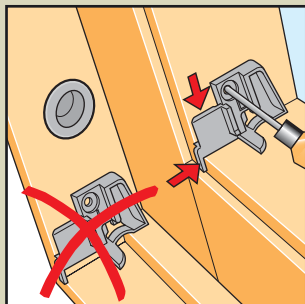
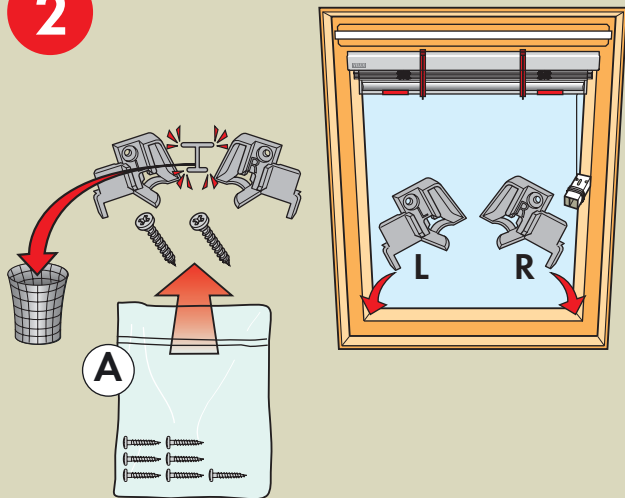

3

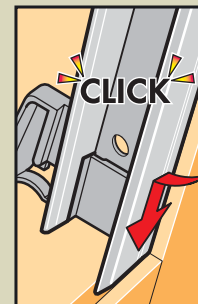
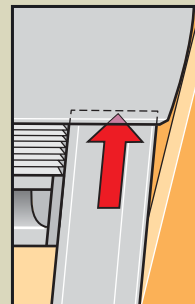
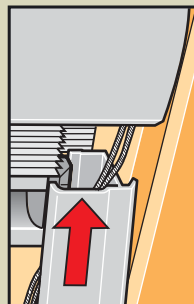
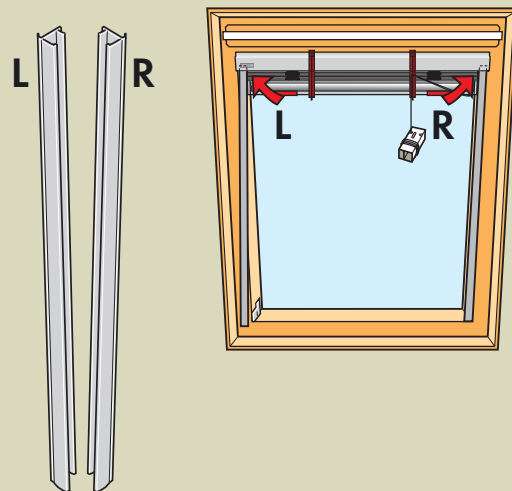

4

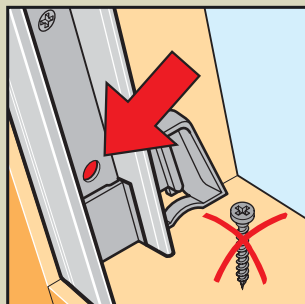
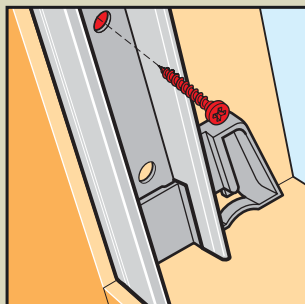
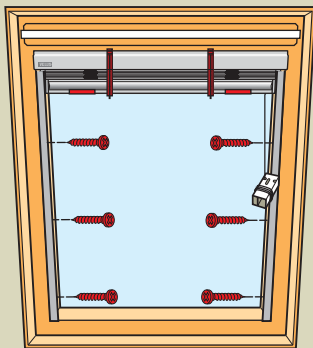
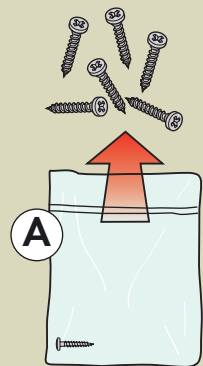

5

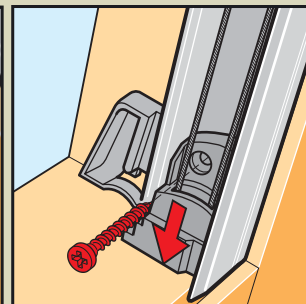
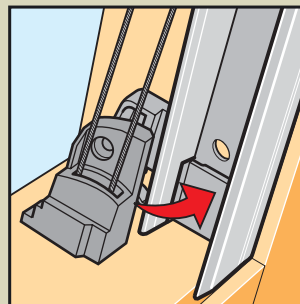
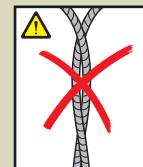
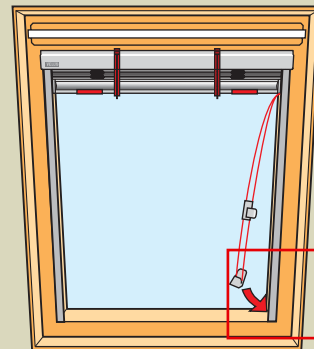
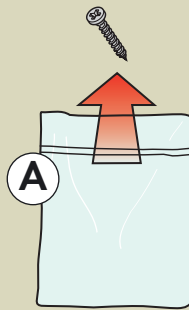

6

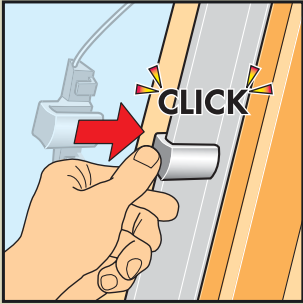
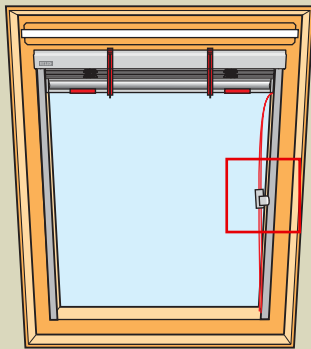

7

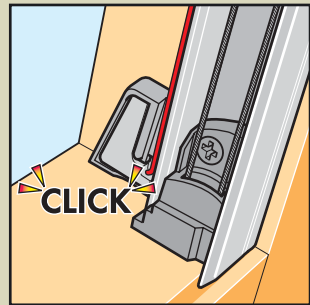
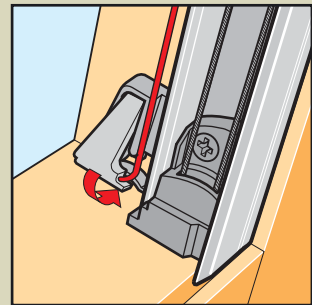
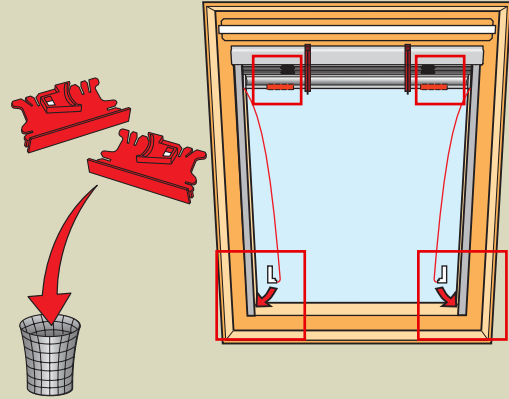

8

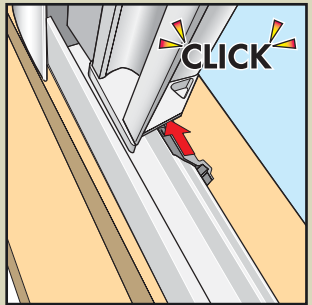
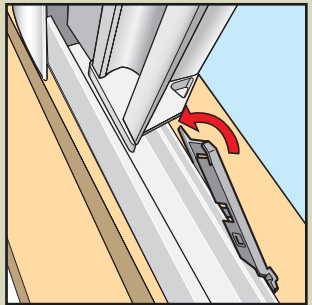
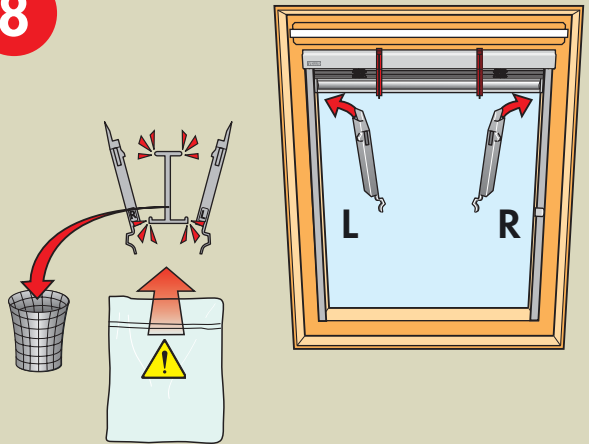

9

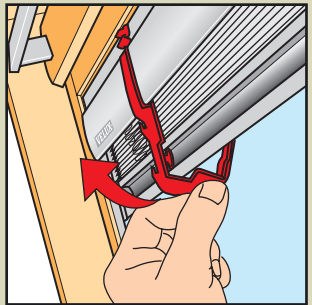
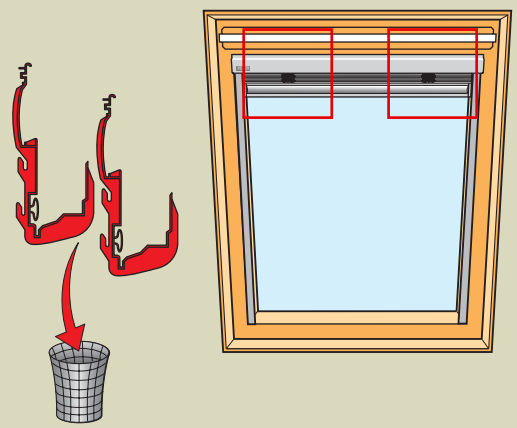

10

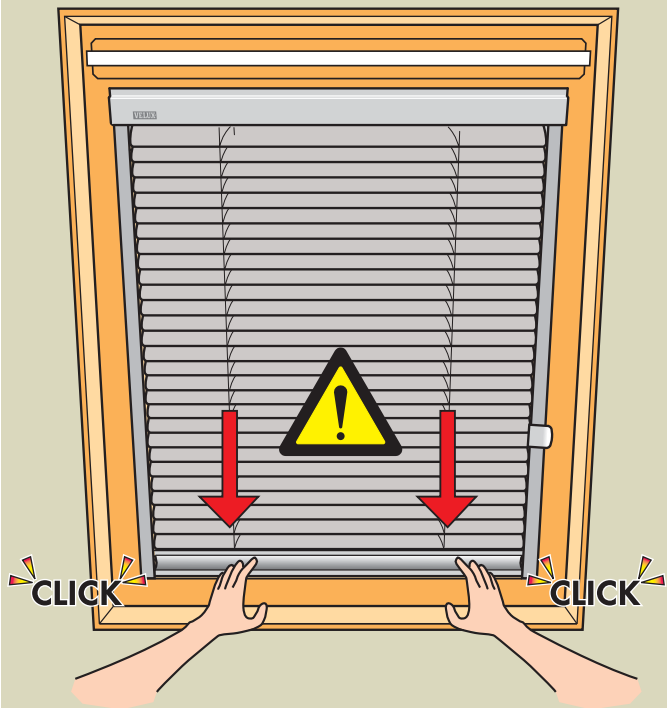

11

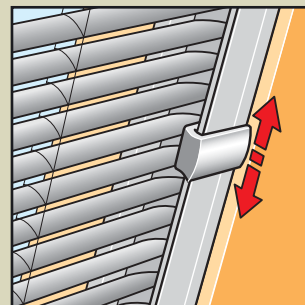
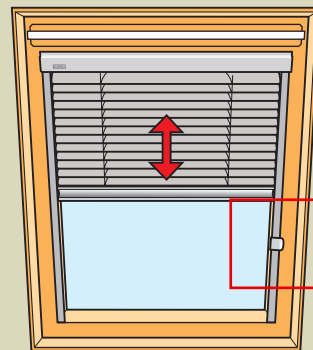

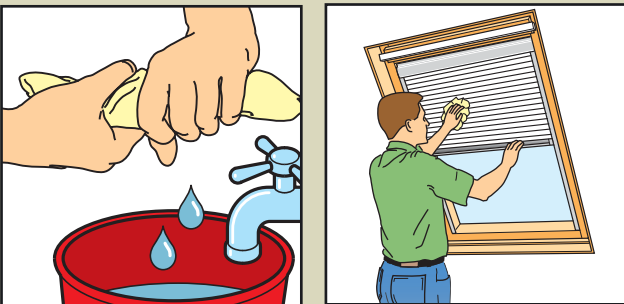

Montage im...

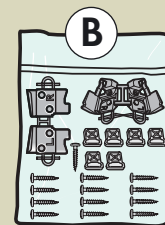
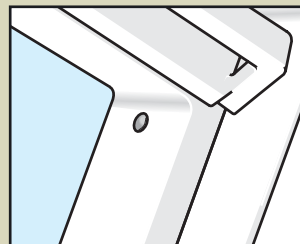
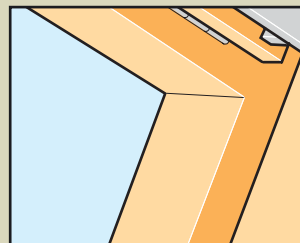

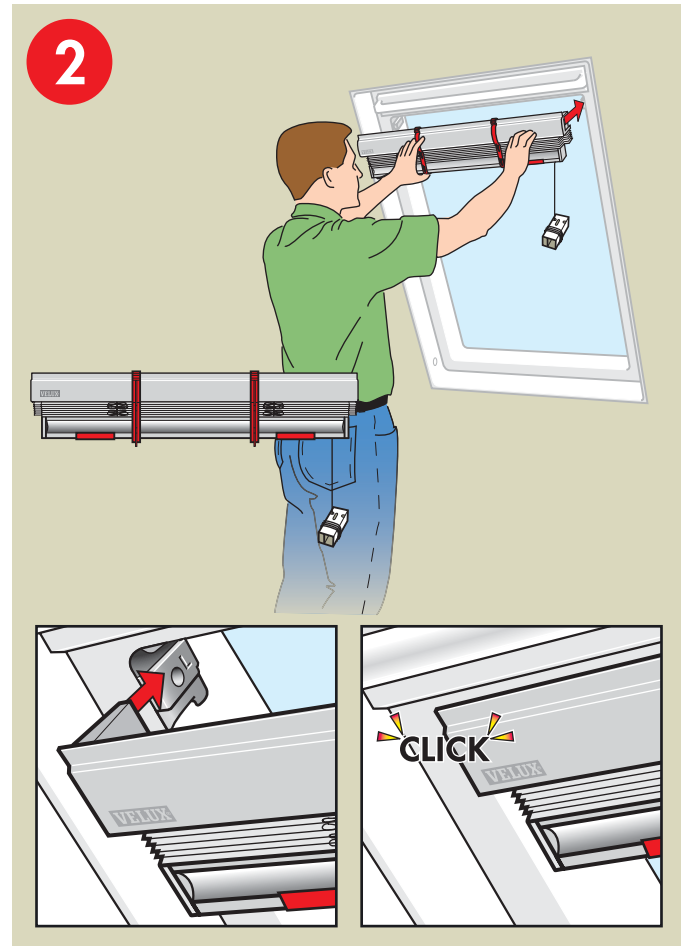
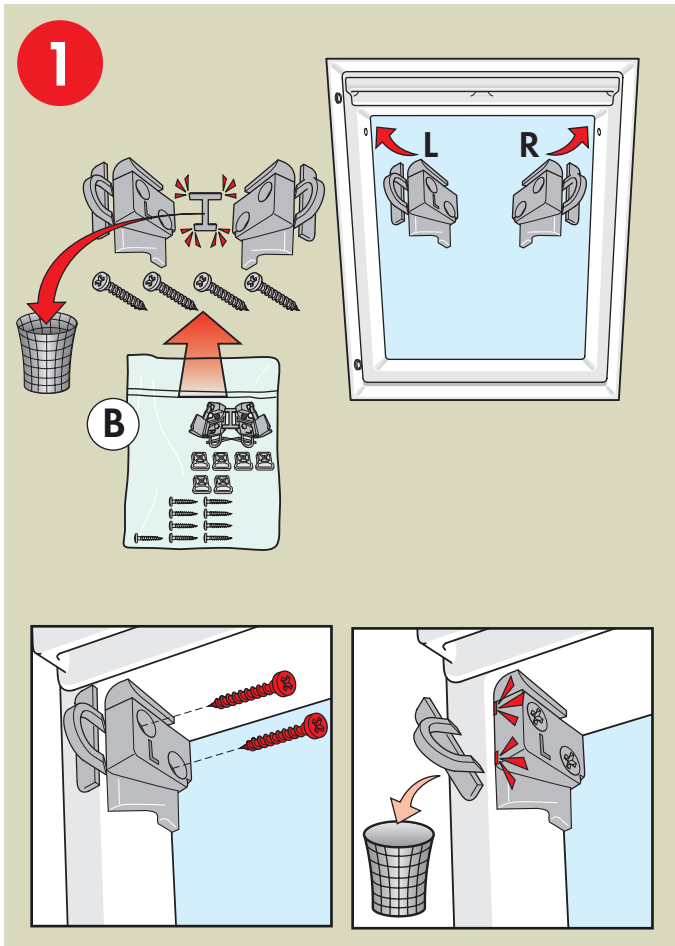

3

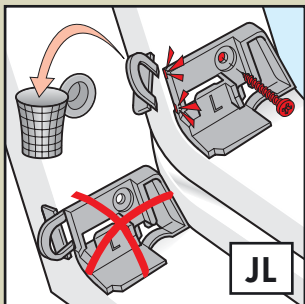
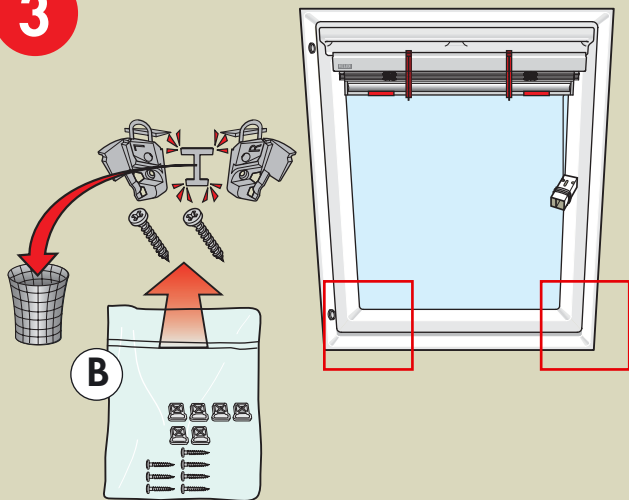

JL

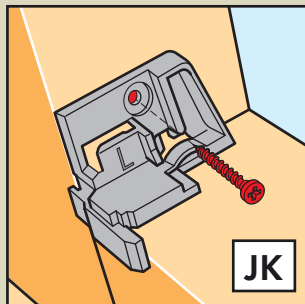

JK

4

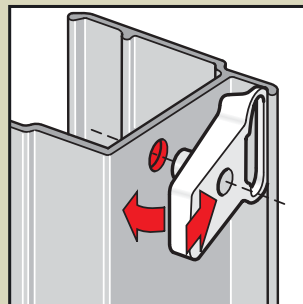
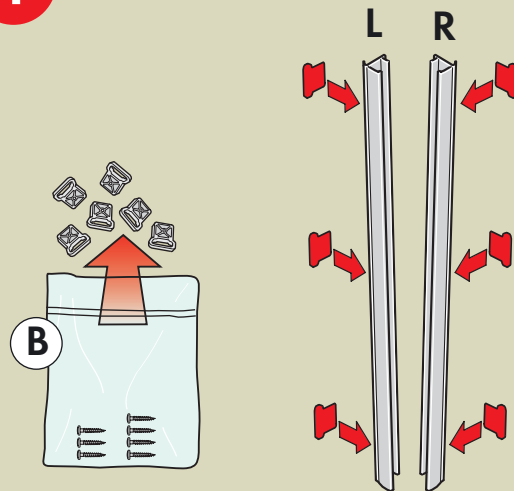

5

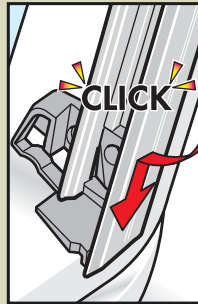
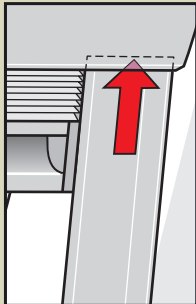
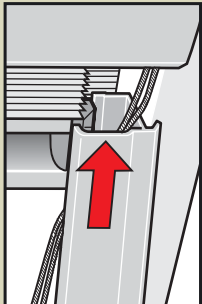
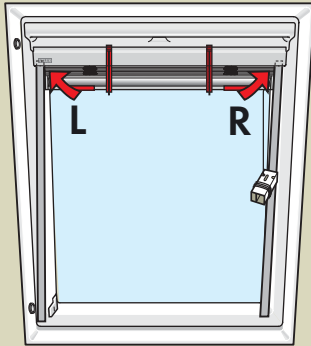
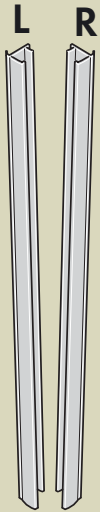

6

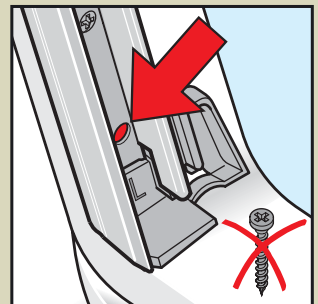
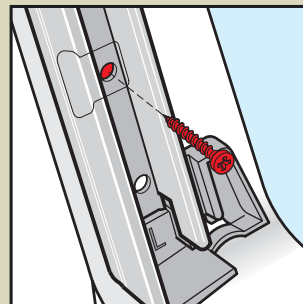
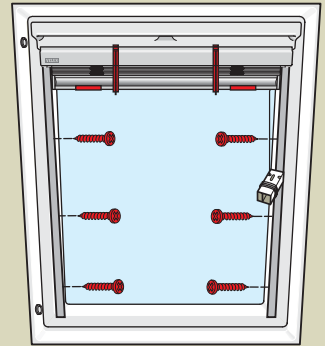
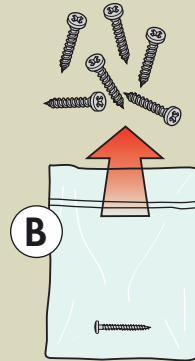

7

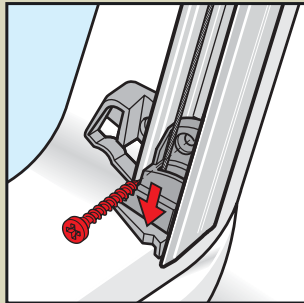
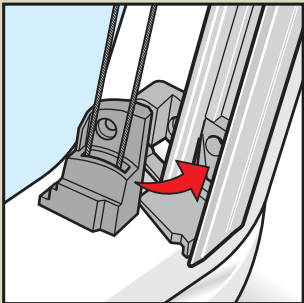
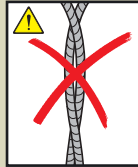
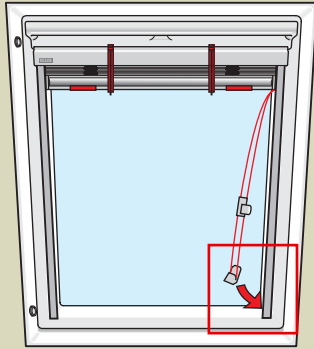
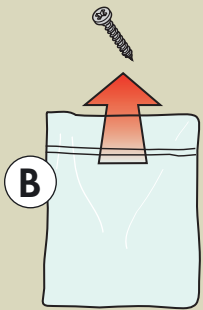

8

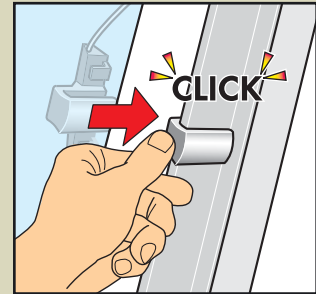
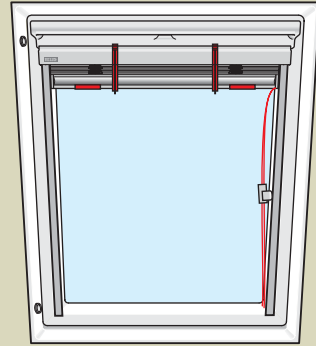

9

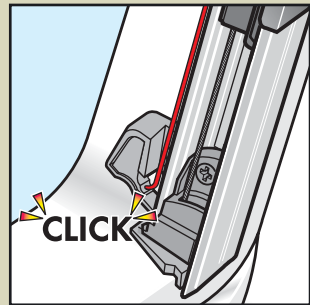
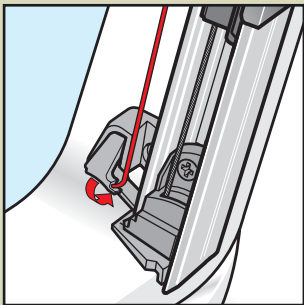
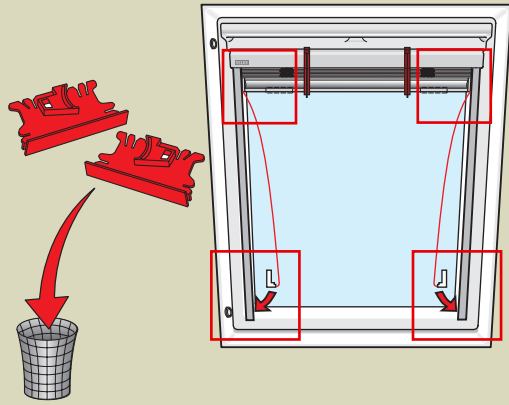

10

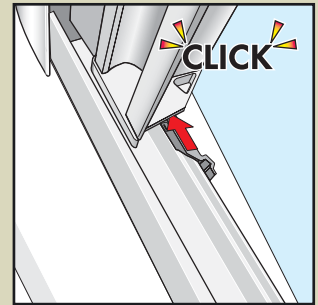
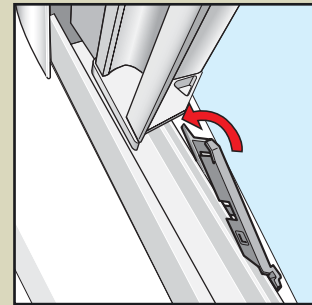
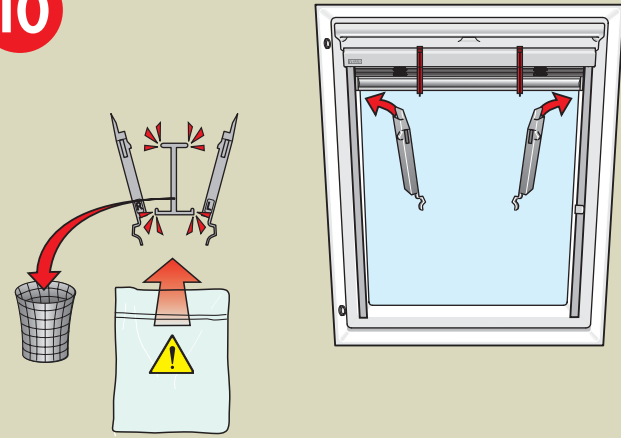

11

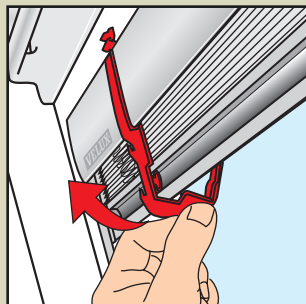
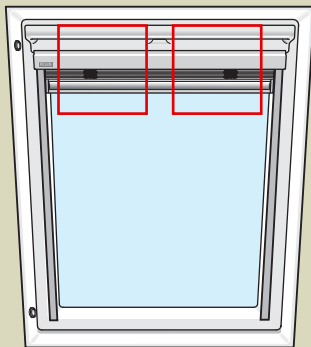
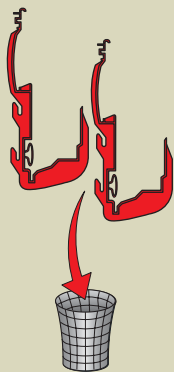

12

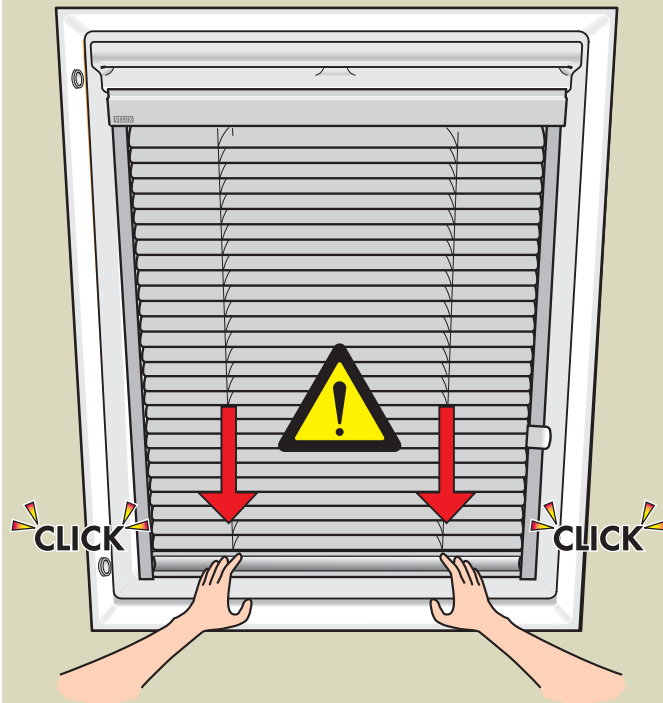

13

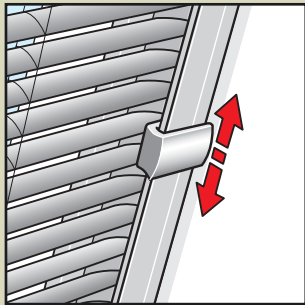
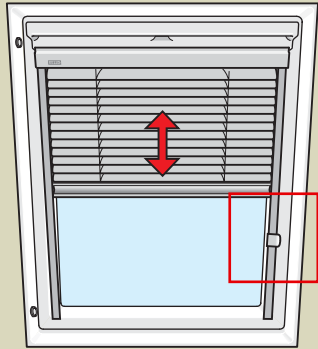

Sollten Sie weitere Informationen über den Einbau dieses Produktes wünschen, rufen Sie uns bitte an.

VELUX Deutschland GmbH

 0180-333 33 99

www.VELUX.com

Montageanleitung für Jalousette. Bestellnr. VAS 451459-0805

©2004, 2005 VELUX Group

©VELUX und VELUX logo sind eingetragene Marken, die der VELUX Group als Lizenz erteilt sind